

用地の地形現況（現況測量図）

3-002[△]

2-001[△]

3-001[△]

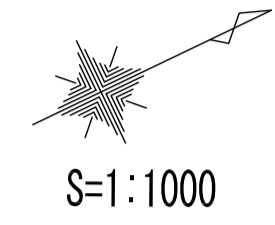

柳生川

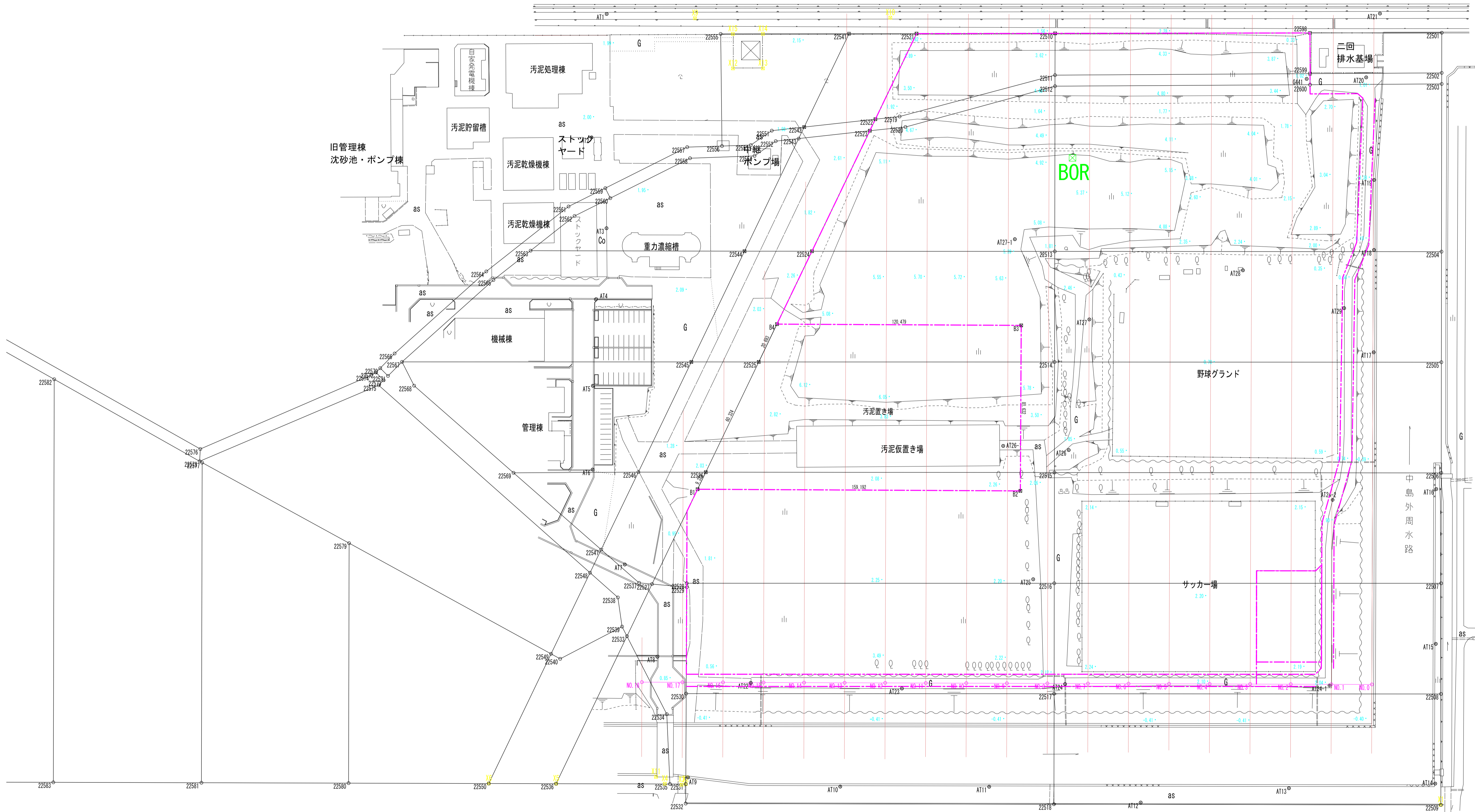

別紙6-1 地形現況

面積 (座 標 法) 計 算 書

地 番 : 地区

| 測点名 | [1] X(i) | [2] X(i+1)-X(i-1) | [3] Y(i) | [4] Y(i+1)-Y(i-1) | [2]*[3] | [1]*[4] | 方向角 | 夾 角 | 距 離 |
|-------|-------------|----------------------|-------------|----------------------|-----------------|------------------|-----------|-----------|----------|
| 22521 | -139945.616 | -98.203 | 17049.885 | -0.177 | -1674349.856655 | 24770.374032 | 141-17-52 | 115-45-37 | 46.830 |
| 22522 | -139982.163 | -41.463 | 17079.166 | 33.220 | -708153.459858 | -4650207.454860 | 141-17-52 | 180-00-00 | 6.299 |
| 22523 | -139987.079 | -56.384 | 17083.105 | 45.176 | -963213.792320 | -6324056.280904 | 141-17-52 | 180-00-00 | 65.950 |
| 22524 | -140038.547 | -82.590 | 17124.342 | 66.173 | -1414299.405780 | -9266770.770631 | 141-17-52 | 180-00-00 | 39.880 |
| B4 | -140069.669 | 77.233 | 17149.278 | 77.609 | 1324490.187774 | -10870666.941421 | 25-55-32 | 64-37-40 | 120.479 |
| B3 | -139961.314 | 72.665 | 17201.951 | 126.090 | 1249979.769415 | -17647722.082260 | 115-55-32 | 270-00-00 | 81.632 |
| B2 | -139997.004 | -178.861 | 17275.368 | 3.818 | -3089889.595848 | -534508.561272 | 205-55-32 | 270-00-00 | 159.192 |
| B1 | -140140.175 | -152.553 | 17205.769 | -62.082 | -2624791.678257 | 8700182.344350 | 141-17-52 | 115-22-20 | 12.022 |
| B5 | -140149.557 | -24.881 | 17213.286 | 39.495 | -428283.768966 | -5535206.753715 | 115-51-27 | 154-33-35 | 35.536 |
| 22528 | -140165.056 | -16.360 | 17245.264 | 33.750 | -282132.519040 | -4730570.640000 | 115-54-56 | 180-03-29 | 1.970 |
| 22529 | -140165.917 | -19.625 | 17247.036 | 40.352 | -338473.081500 | -5655975.082784 | 115-56-11 | 180-01-15 | 42.901 |
| B6 | -140184.681 | 234.755 | 17285.616 | 160.229 | 4057884.784080 | -22461651.251949 | 25-38-01 | 89-41-50 | 281.195 |
| B14 | -139931.162 | 275.655 | 17407.265 | 75.655 | 4798399.633575 | -10586492.061110 | 295-42-02 | 90-04-01 | 51.044 |
| B15 | -139909.026 | 48.393 | 17361.271 | -33.357 | 840163.987503 | 4666945.380282 | 25-42-02 | 270-00-00 | 29.140 |
| B16 | -139882.769 | 30.270 | 17373.908 | 11.235 | 525908.195160 | -1571582.909715 | 340-44-39 | 135-02-37 | 4.251 |
| B17 | -139878.756 | 12.963 | 17372.506 | -19.870 | 225199.795278 | 2779390.881720 | 295-51-17 | 135-06-38 | 20.522 |
| B9 | -139869.806 | 30.628 | 17354.038 | -43.282 | 531519.475864 | 6053844.943292 | 311-08-28 | 195-17-11 | 32.950 |
| G1214 | -139848.128 | 61.694 | 17329.224 | -104.852 | 1069109.145456 | 14663355.917056 | 296-33-48 | 165-25-20 | 89.484 |
| G1234 | -139808.112 | 53.711 | 17249.186 | -92.642 | 926471.029246 | 12952103.111904 | 317-22-40 | 200-48-52 | 18.612 |
| G1243 | -139794.417 | 47.184 | 17236.582 | -75.435 | 813290.885088 | 10545391.846395 | 298-03-25 | 160-40-45 | 71.199 |
| B18 | -139760.928 | 32.175 | 17173.751 | -65.872 | 552565.438425 | 9206331.849216 | 246-38-06 | 128-34-41 | 3.313 |
| B13 | -139762.242 | -22.572 | 17170.710 | -13.086 | -387577.266120 | 1828928.698812 | 205-17-32 | 138-39-26 | 23.512 |
| B12 | -139783.500 | -19.298 | 17160.665 | -14.149 | -331166.513170 | 1977796.741500 | 295-32-13 | 270-14-41 | 4.548 |
| 22600 | -139781.540 | 4.311 | 17156.561 | -9.023 | 73961.934471 | 1261248.835420 | 295-32-12 | 179-59-59 | 5.452 |
| 22599 | -139779.189 | 11.002 | 17151.642 | -23.026 | 188702.365284 | 3218555.605914 | 295-32-13 | 180-00-01 | 20.067 |
| 22598 | -139770.538 | -104.771 | 17133.535 | -72.299 | -1795097.595485 | 10105270.126862 | 205-32-17 | 90-00-04 | 125.703 |
| 22510 | -139883.960 | -175.078 | 17079.343 | -83.650 | -2990217.213754 | 11701293.254000 | 205-32-15 | 179-59-58 | 68.332 |
| 合計 | | | | 倍面積 | 150000.879866 | -150000.879866 | | | 1462.015 |
| | | | | 面積 | 75000.4399330 | 75000.4399330 | | | |
| | | | | 坪数 | 22687.63 | 22687.63 | | | |

横断面図面 (HD=1:500, HV=1:500)

5-1 (NO.0~NO.3)

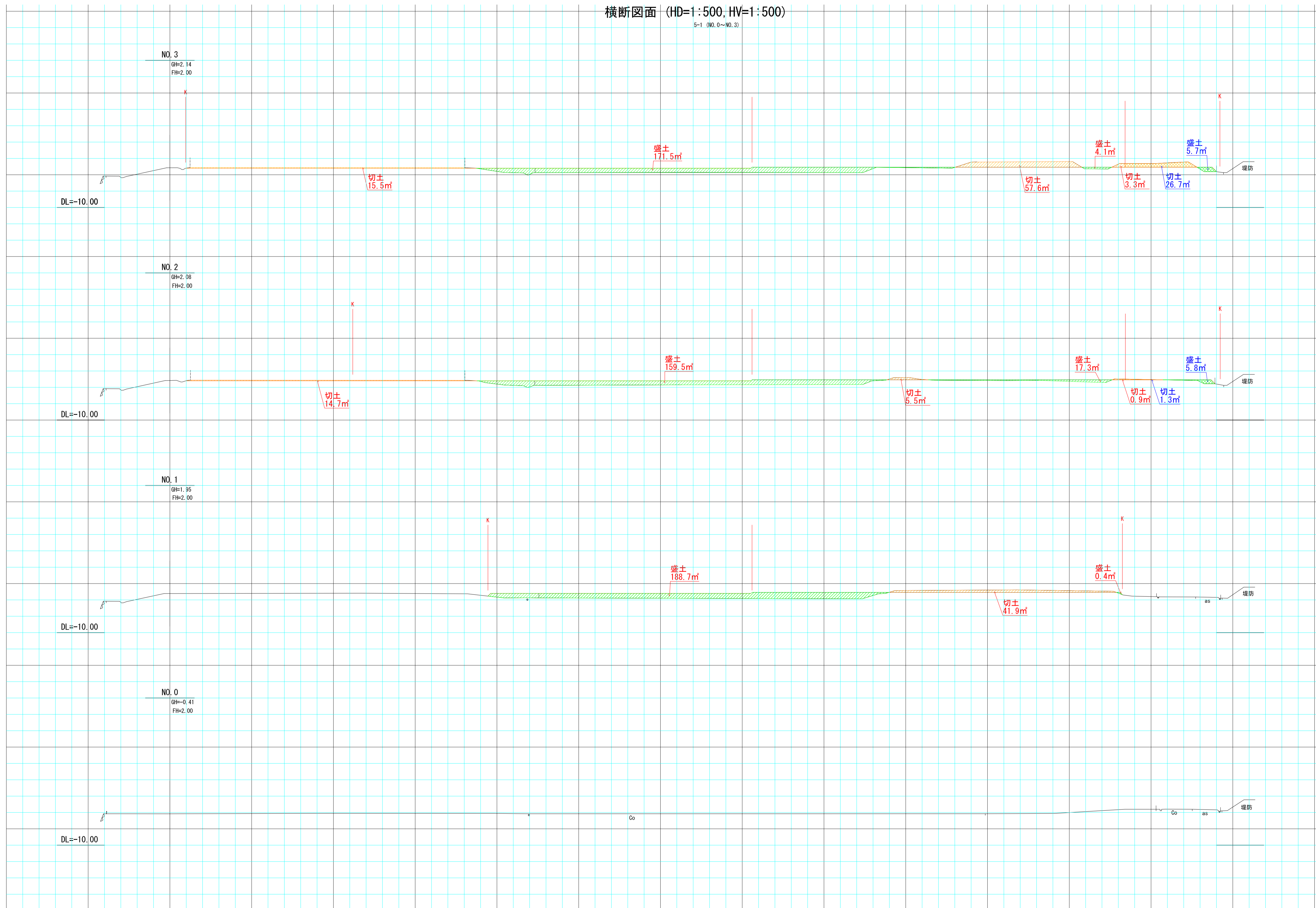

横断面図面 (HD=1:500, HV=1:500)

5-2 (NO.4~NO.7)

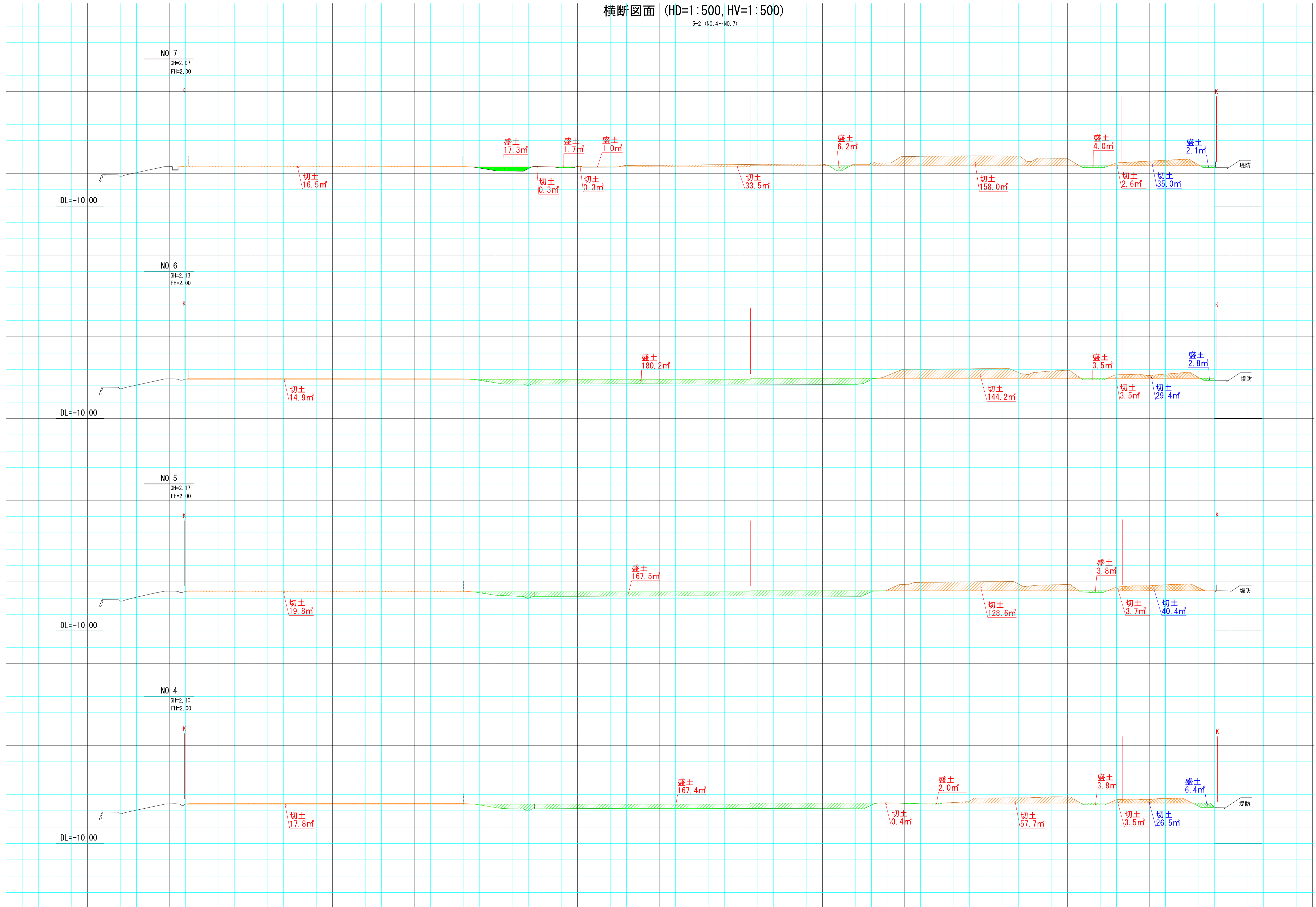

横断面図面 (HD=1:500, HV=1:500)
5-3 (NO.8~NO.11)

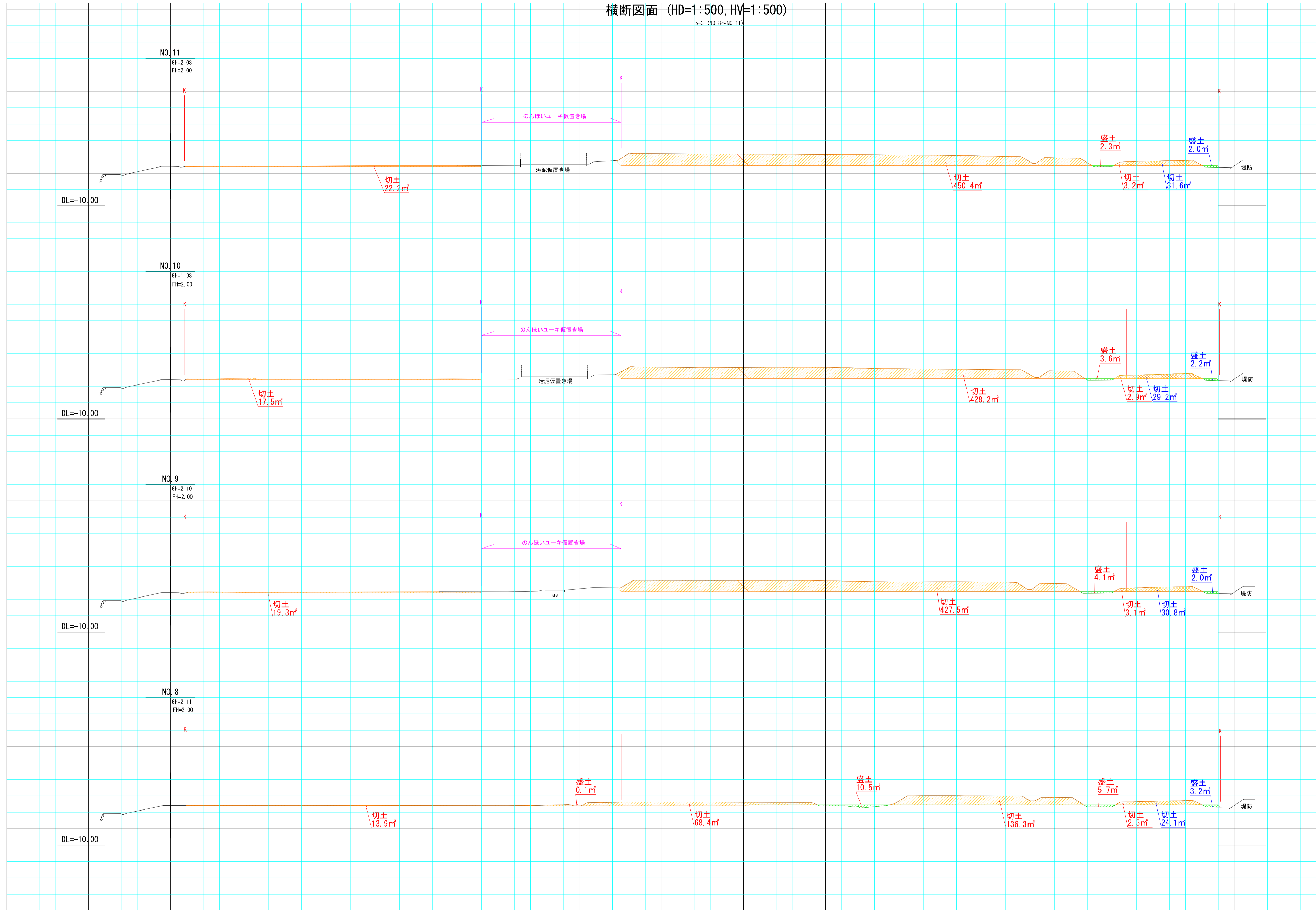

横断面図 (HD=1:500, HV=1:500)
5-4 (NO.12~NO.15)

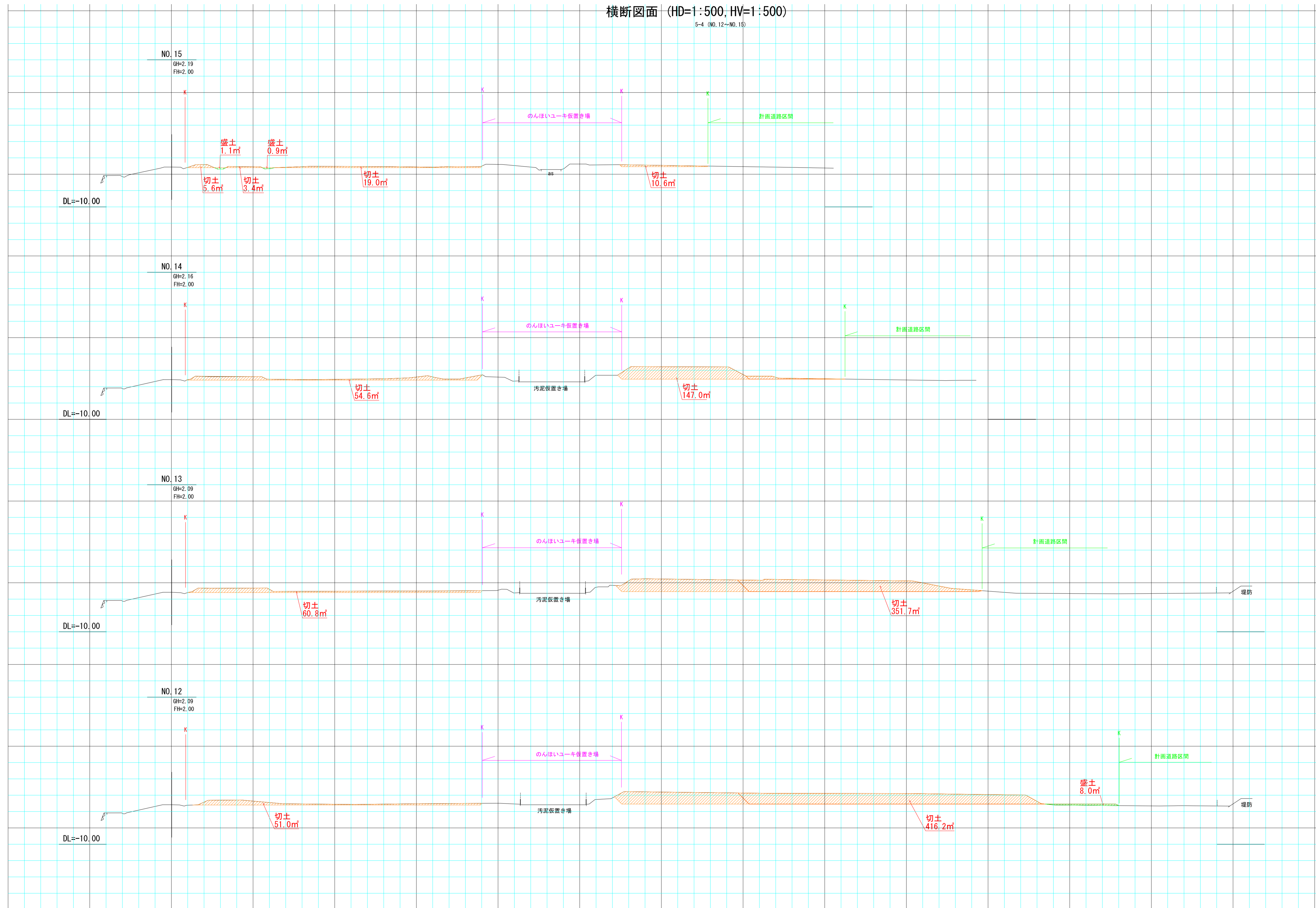

横断面図面 (HD=1:500, HV=1:500)

5-5 (NO.16~NO.18)



別紙6-1 地形現況

| 土 量 計 算 書 | | | | | | | | | | |
|-----------|-------|-------|--------|---------|-------|--------|---------|----|----|----|
| 測点 | 距離 | 切土 | | | 盛土 | | | 断面 | 平均 | 面積 |
| | | 断面 | 平均 | 面積 | 断面 | 平均 | 面積 | | | |
| NO. 0 | 0.0 | 0.0 | | 0.0 | 0.0 | | | | | |
| NO. 1 | 20.0 | 41.9 | 20.95 | 419.0 | 189.1 | 94.55 | 1891.0 | | | |
| NO. 2 | 20.0 | 21.1 | 31.50 | 630.0 | 176.8 | 182.95 | 3659.0 | | | |
| NO. 3 | 20.0 | 76.4 | 48.75 | 975.0 | 175.6 | 176.20 | 3524.0 | | | |
| NO. 4 | 20.0 | 79.4 | 77.90 | 1558.0 | 173.2 | 174.40 | 3488.0 | | | |
| NO. 5 | 20.0 | 152.1 | 115.75 | 2315.0 | 171.3 | 172.25 | 3445.0 | | | |
| NO. 6 | 20.0 | 162.6 | 157.35 | 3147.0 | 183.7 | 177.50 | 3550.0 | | | |
| NO. 7 | 20.0 | 211.2 | 186.90 | 3738.0 | 30.2 | 106.95 | 2139.0 | | | |
| NO. 8 | 20.0 | 220.9 | 216.05 | 4321.0 | 16.3 | 23.25 | 465.0 | | | |
| NO. 9 | 20.0 | 449.9 | 335.40 | 6708.0 | 4.1 | 10.20 | 204.0 | | | |
| NO. 10 | 20.0 | 448.6 | 449.25 | 8985.0 | 3.6 | 3.85 | 77.0 | | | |
| NO. 11 | 20.0 | 475.8 | 462.20 | 9244.0 | 2.3 | 2.95 | 59.0 | | | |
| NO. 12 | 20.0 | 467.2 | 471.50 | 9430.0 | 8.0 | 5.15 | 103.0 | | | |
| NO. 13 | 20.0 | 412.5 | 439.85 | 8797.0 | 0.0 | 4.00 | 80.0 | | | |
| NO. 14 | 20.0 | 201.6 | 307.05 | 6141.0 | 0.0 | 0.00 | 0.0 | | | |
| NO. 15 | 20.0 | 39.5 | 120.55 | 2411.0 | 1.1 | 0.55 | 11.0 | | | |
| NO. 16 | 20.0 | 2.7 | 21.10 | 422.0 | 41.9 | 21.50 | 430.0 | | | |
| NO. 17 | 20.0 | 0.0 | 1.35 | 27.0 | 0.0 | 20.95 | 419.0 | | | |
| NO. 18 | 20.0 | 0.0 | 0.00 | 0.0 | 0.0 | 0.00 | 0.0 | | | |
| | | | | | | | | | | |
| | | | | | | | | | | |
| | | | | | | | | | | |
| | | | | | | | | | | |
| 合計 | 360.0 | | | 69268.0 | | | 23544.0 | | | |

ボーリング柱状図

調査名 中島処理場用地測量等業務

ボーリングNo

事業・工事名

シートNo

| | | | | | | | | | | | | |
|--------|---------------------------------|------|---------------|------------------------------|------|------|----------|------|--------|------|------|------|
| ボーリング名 | No. 1 | 調査位置 | 愛知県豊橋市神野新田町地内 | | | | 北緯 | | | | | |
| 発注機関 | 豊橋市上下水道局 | | 調査期間 | 平成 25年 10月 28日 ~ 25年 10月 29日 | | 東経 | | | | | | |
| 調査業者名 | 東海ジオテック株式会社 電話(0532-25-7766) | 担技術者 | 高橋幸伸 | 管理技術者 | コ鑑ア者 | 小田朋紀 | ボーリング責任者 | 小田朋紀 | | | | |
| 孔口標高 | H=5.31m | 角 | 180° | 方 | 北0° | 地盤勾配 | 水平0° | 使用機種 | YBM-05 | ハンマー | 落下用具 | 半自動型 |
| 総掘進長 | 25.35m | 度 | 上90° | 向 | 270° | 鉛直 | 90° | エンジン | NFD9 | ポンプ | | V-6 |

| 標高(m) | 層厚(m) | 深度(m) | 柱状図 | 土質区分 | 色調 | 相対密度 | 相対稠度 | 記 | 孔内水位(m) / 測定月日 | 標準貫入試験 | | | | | 原位置試験 | 試験名および結果 | 試料採取 | 室内試験 | 掘進 |
|-------|-------|-------|-------|------|----|------|------|---|----------------|--------|-------------|---|----|--------------|-------|----------|------|------|----|
| | | | | | | | | | | 深(m) | 10cmごとの打撃回数 | | | 打撃回数/貫入量(cm) | | | | | |
| 1 | | | | 盛土 | 淡灰 | 茶灰 | | GL-0.03mまで腐植土 GL-2.66mまで礫混じり細砂 含水少ない 径2~30mm程度の円礫混入 GL-1.25m付近で 腐植物及び炭化物混入 GL-3.90mまで砂礫 風化礫主体 径2~50mm程度の円礫混入 GL-3.65m付近で 径150mm程度の玉石混入 以深、粘土混じり砂礫 含水多い 泥礫主体 径2~40mm程度の角礫混入 GL-5.00m付近で100%透水する | 10/29 | 1.15 | 1 | 2 | 2 | 5 | 4 | | | | |
| 2 | | | | | | | | | 1.50 | 2 | 2 | 4 | 8 | 8 | | | | | |
| 3 | | | | | | | | | 2.15 | 2 | 2 | 4 | 8 | 30 | | | | | |
| 4 | | | | | | | | | 2.45 | 9 | 8 | 7 | 24 | 24 | | | | | |
| 5 | | | | | | | | | 3.15 | 9 | 8 | 7 | 24 | 30 | | | | | |
| 6 | | | 3.45 | 2 | 2 | 1 | 5 | 4 | | | | | | | | | | | |
| 7 | | | 4.15 | 2 | 2 | 1 | 5 | 35 | 4.83 | | | | | | | | | | |
| 8 | | | 4.50 | 2 | 2 | 2 | 6 | 30 | | | | | | | | | | | |
| 9 | | | 5.15 | 2 | 2 | 2 | 6 | 30 | | | | | | | | | | | |
| 10 | | | 5.45 | 2 | 2 | 2 | 6 | 30 | | | | | | | | | | | |
| 11 | | | 6.15 | 2 | 2 | 2 | 6 | 30 | | | | | | | | | | | |
| 12 | | | 6.45 | 6 | 4 | 5 | 15 | 30 | | | | | | | | | | | |
| 13 | | | 7.15 | 6 | 4 | 5 | 15 | 30 | | | | | | | | | | | |
| 14 | | | 7.45 | 3 | 2 | 2 | 7 | 30 | | | | | | | | | | | |
| 15 | | | 8.15 | 3 | 2 | 2 | 7 | 30 | | | | | | | | | | | |
| 16 | | | 8.45 | 6 | 6 | 7 | 19 | 30 | | | | | | | | | | | |
| 17 | | | 9.15 | 6 | 6 | 7 | 19 | 30 | | | | | | | | | | | |
| 18 | | | 9.45 | 10 | 9 | 7 | 26 | 30 | | | | | | | | | | | |
| 19 | | | 10.15 | 10 | 11 | 11 | 32 | 30 | | | | | | | | | | | |
| 20 | | | 10.45 | 10 | 11 | 11 | 32 | 30 | | | | | | | | | | | |
| 21 | | | 11.15 | 4 | 15 | 8 | 27 | 30 | | | | | | | | | | | |
| 22 | | | 11.45 | 4 | 15 | 8 | 27 | 30 | | | | | | | | | | | |
| 23 | | | 12.15 | 3 | 3 | 3 | 9 | 30 | | | | | | | | | | | |
| 24 | | | 12.45 | 3 | 3 | 3 | 9 | 30 | | | | | | | | | | | |
| 25 | | | 13.15 | 3 | 3 | 3 | 9 | 30 | | | | | | | | | | | |
| 26 | | | 13.45 | 1 | 1 | 1 | 3 | 35 | | | | | | | | | | | |
| 27 | | | 14.15 | 1 | 1 | 1 | 3 | 35 | | | | | | | | | | | |
| 28 | | | 14.50 | 0 | 2 | 2 | 2 | 30 | | | | | | | | | | | |
| 29 | | | 15.15 | 0 | 2 | 2 | 2 | 30 | | | | | | | | | | | |
| 30 | | | 15.45 | 10 | 5 | 4 | 19 | 30 | | | | | | | | | | | |
| 31 | | | 16.15 | 10 | 5 | 4 | 19 | 30 | | | | | | | | | | | |
| 32 | | | 16.45 | 38 | 12 | 4 | 50 | 14 | | | | | | | | | | | |
| 33 | | | 17.15 | 38 | 12 | 4 | 50 | 14 | | | | | | | | | | | |
| 34 | | | 17.29 | 45 | 5 | 2 | 50 | 12 | | | | | | | | | | | |
| 35 | | | 18.15 | 45 | 5 | 2 | 50 | 12 | | | | | | | | | | | |
| 36 | | | 18.27 | 45 | 5 | 2 | 50 | 12 | | | | | | | | | | | |
| 37 | | | 18.27 | 45 | 5 | 2 | 50 | 12 | | | | | | | | | | | |
| 38 | | | 19.15 | 13 | 20 | 17 | 50 | 28 | | | | | | | | | | | |
| 39 | | | 19.43 | 15 | 18 | 17 | 50 | 28 | | | | | | | | | | | |
| 40 | | | 20.15 | 15 | 18 | 17 | 50 | 28 | | | | | | | | | | | |
| 41 | | | 20.43 | 36 | 14 | 3 | 50 | 13 | | | | | | | | | | | |
| 42 | | | 21.15 | 36 | 14 | 3 | 50 | 13 | | | | | | | | | | | |
| 43 | | | 21.28 | 50 | 5 | 5 | 50 | 5 | | | | | | | | | | | |
| 44 | | | 22.15 | 50 | 5 | 5 | 50 | 5 | | | | | | | | | | | |
| 45 | | | 22.20 | 50 | 5 | 5 | 50 | 5 | | | | | | | | | | | |
| 46 | | | 23.15 | 14 | 19 | 17 | 50 | 28 | | | | | | | | | | | |
| 47 | | | 23.43 | 18 | 22 | 10 | 50 | 23 | | | | | | | | | | | |
| 48 | | | 24.15 | 18 | 22 | 10 | 50 | 23 | | | | | | | | | | | |
| 49 | | | 24.38 | 18 | 22 | 10 | 50 | 23 | | | | | | | | | | | |
| 50 | | | 25.15 | 18 | 32 | 50 | 20 | | | | | | | | | | | | |
| 51 | | | 25.35 | 18 | 32 | 50 | 20 | | | | | | | | | | | | |