

The Household Garbage Guide

Take the lead in making Toyohashi garbage free!



- Sorting Flowchart P1
- How to dispose garbage at the Garbage Station P2
- Burnable Garbage P3
- Kitchen Waste P4
- Bottles & Cans P5
- Recyclable Plastics P6
- PET Bottles P7
- Hazardous Garbage P8
- Crushable Garbage P9
- Cloths P10
- Landfill Garbage P11
- Waste Paper P12
- Bulky Garbage P13
- 4 Special Appliances P14
- Computers P15
- Small Appliances P16
- Easy Reference Table P17~25
- Topics P26
- List of facilities where garbage can be disposed P27·28
- Garbage Disposal Map P29·30
- Contact P31

Do you want to dispose garbage easier?

Line version of "Gomimaru"
 Add "Gomimaru" in LINE, and it will answer the sorting of garbage and the garbage collection days by just asking in the talk page. You can also check the calendar of garbage collection days!



Register from here!

An app to promote sorting garbage called "San aru"
 You can set the notification settings of garbage collection days, and check the sorting of garbage, garbage collection days, and garbage collection facilities.



*Free to register and use, but subject to data fees.

Toyohashi City, Environment Division
<https://www.city.toyohashi.lg.jp/8391.htm>

Toyohashi City Homepage ⇒ Life ⇒ Garbage / Environment ⇒ Garbage Sorting ⇒ How to sort garbage in Toyohashi

Sorting Flowchart

Please be careful, for it differs depending on the kinds and sizes of the garbage.

Designated items including microwave ovens, carpets, and chairs. *Check page 13 for details.

Bulky Garbage: Page 13

Appliances

4 Special Appliances (televisions, refrigerators/freezers, washing machine/driers, and air conditioners)

4 Special Appliances: Page 14

Computers (desktops, laptops)

Computers: Page 15

*Under 60 cm (except for 4 special appliances and computers)

Crushable Garbage: Page 9
Small Appliances: Page 16

*60 cm or more (except for 4 special appliances and computers)

Bulky Garbage: Page 13

Daily Necessities (Except for appliances)

Containing metal

*Under 120 cm

Crushable Garbage: Page 9

*120 cm or more

Bulky Garbage: Page 13

Not containing metal

*Under 30 cm

Burnable Garbage: Page 3
Crushable Garbage: Page 9

Under 30 - 120cm

Crushable Garbage: Page 9

*120 cm or more

Bulky Garbage: Page 13

*The length of the longest side.

Furniture

Height under 90 cm
Width under 120 cm

Crushable Garbage: Page 9

Height of 90 cm or more
Or
Width of 120 cm or more

Bulky Garbage: Page 13

How to dispose garbage at the Garbage Station

Please follow these rules and manners for taking out and sorting garbage

- Bring garbage on the set days.
- Bring garbage between dawn and 8:30 AM on garbage collection days.
- Bring garbage to garbage stations on the set days of your area.
- Please separate garbage into specified bags and tie the bags at the top.
- **Garbage stations are for household garbage only.**

Garbage Bag

Designated Bags

Burnable Garbage

Sizes: 45 L, 30 L, 20 L, 10 L



Crushable Garbage

Sizes: 45 L, 30 L, 20 L, 10 L

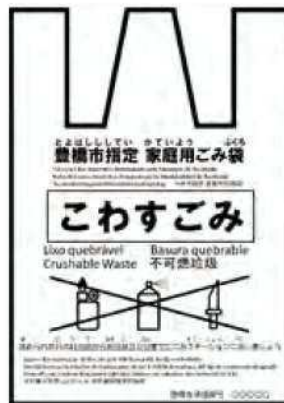

Kitchen Waste

Sizes: 30 L, 15 L, 10 L, 5 L, 2L

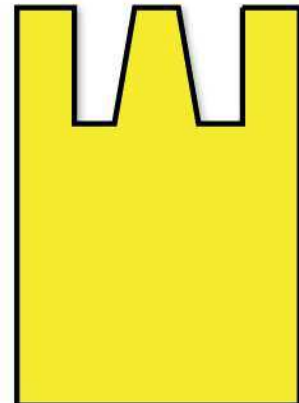

*Designated garbage bags are sold at local supermarkets, home centers, and convenience stores.

Transparent or translucent bags

Bottles & Cans

Recyclable Plastics

PET Bottles

Cloths

Hazardous Garbage

Landfill Garbage

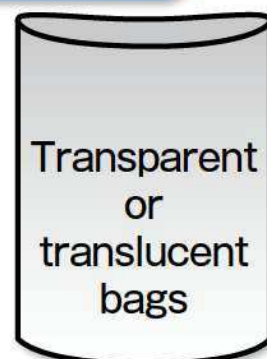

*These are not designated bags.

Items collected at garbage stations / Collection times (twice a week)

Burnable Garbage

Please put in designated garbage bags for disposal.

Please check the collection days on the Clean Calendar.



Disposal

1. Put in a designated garbage bag



2. Dispose at Garbage Station

Please separate burnable garbage and kitchen waste.



Disposal

(Wooden sticks and boards)

Bundle these together and put them out.



*Bundle up to a length of 60 cm or less, and diameter of 30 cm or less

Applicable items

Dirty plastic containers and wrappers



Dirty cloths



Daily necessities which are less than 30cm



*Excludes metal products

Tissues



Thermal paper, pictures



Diapers



*Remove excrement

Dirty papers



*Paper with food residue or oil on it

Used fireworks



*Submerge in water first

Weeds, fallen leaves



Wooden sticks and boards



Leather products



Items collected at garbage stations / Collection times (twice a week)

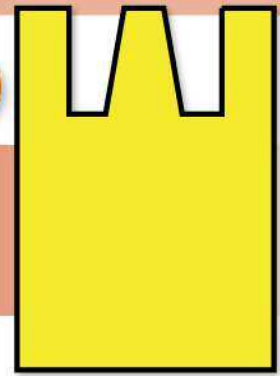

Kitchen Waste

Please put in designated garbage bags for disposal.

Please check the collection days on the Clean Calendar.

Disposal

Do not wrap it in paper bags or newspapers.

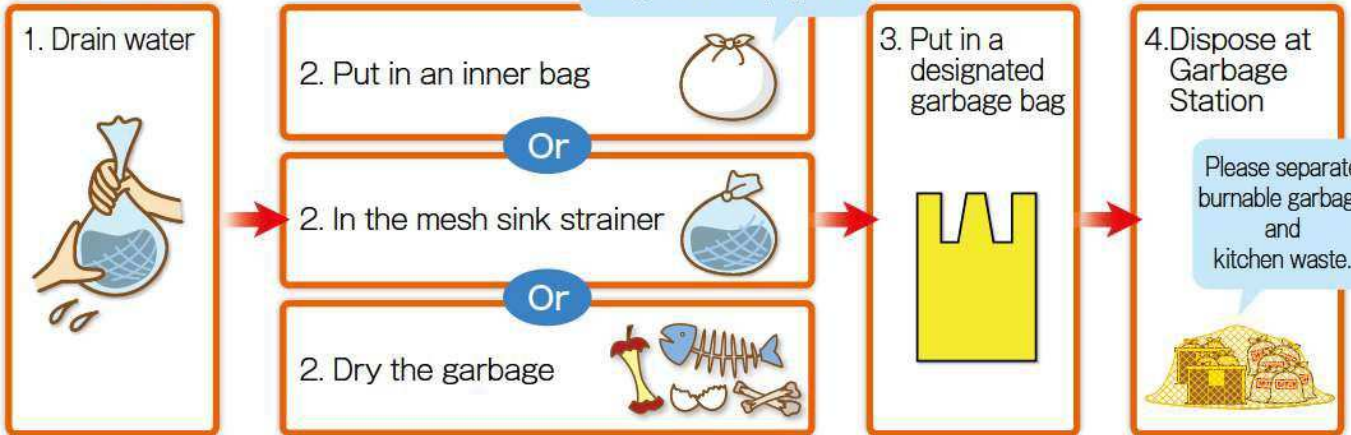

Applicable items

<p>Vegetables, fruits</p>	<p>Side dishes</p>	<p>Grains</p>	<p>Cooking waste, leftovers</p>
<p>Tea, coffee dregs</p> <p>*May be left inside the tea bag or coffee filter</p>	<p>Rotten food</p>	<p>Meat</p>	<p>Seafood</p>

Non-applicable items

<p>Weeds, cut flowers</p>	<p>Medicine</p>	<p>Chewing gum</p>	<p>Cigarettes</p>
---------------------------	-----------------	--------------------	-------------------

Also...

- Cooking oil (hardened oil)
- Toothpaste, etc.

These items are **burnable garbage**.

Items collected at garbage stations / Collection times (once a week)

Bottles & Cans

Put in a transparent or translucent bag.

Transparent or translucent bag

Please check the collection days on the Clean Calendar.

Disposal

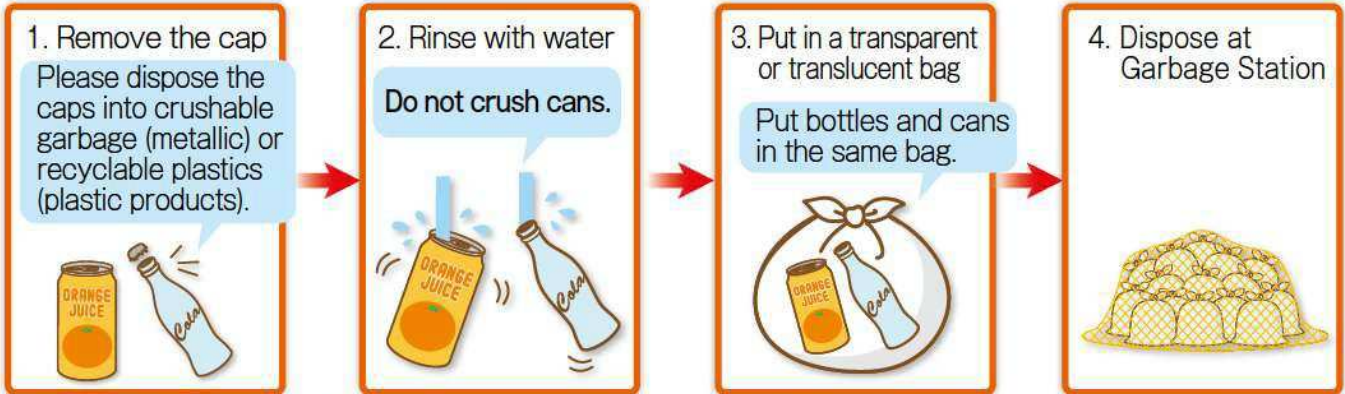

Applicable items Glass bottles

*Bottles of sizes up to wide-mouth bottles such as plum wine bottles, or 1 sho (1.8 L) bottles.

<p>Juice and Japanese sake bottles</p>	<p>Instant coffee and jam bottles</p>	<p>Food bottles, wide mouth bottles</p>	<p>Cosmetics bottles</p>
--	---------------------------------------	---	--------------------------

Applicable items Cans

*Bottles up to the size of powdered milk cans

<p>Aluminum cans</p>	<p>Steel cans</p>	<p>Food cans</p>	<p>Powdered milk cans</p>
----------------------	-------------------	------------------	---------------------------

Non-applicable items

Glass products other than bottles



Landfill Garbage

Metal products other than cans



Crushable Garbage

Spray cans



*Do not pierce holes.
*Please use the contents completely.

Hazardous Garbage

Also...

- Items with things inside
- Items which cannot be cleaned
- Bottles larger than 1.8L
- Cans larger than powdered milk cans, etc.

These items are **Crushable Garbage.**

Items collected at garbage stations / Collection times (once a week)

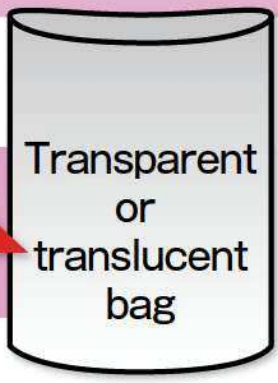

Transparent or translucent bag

Recyclable Plastics

Put in a transparent or translucent bag.

Please check the collection days on the Clean Calendar.

Disposal

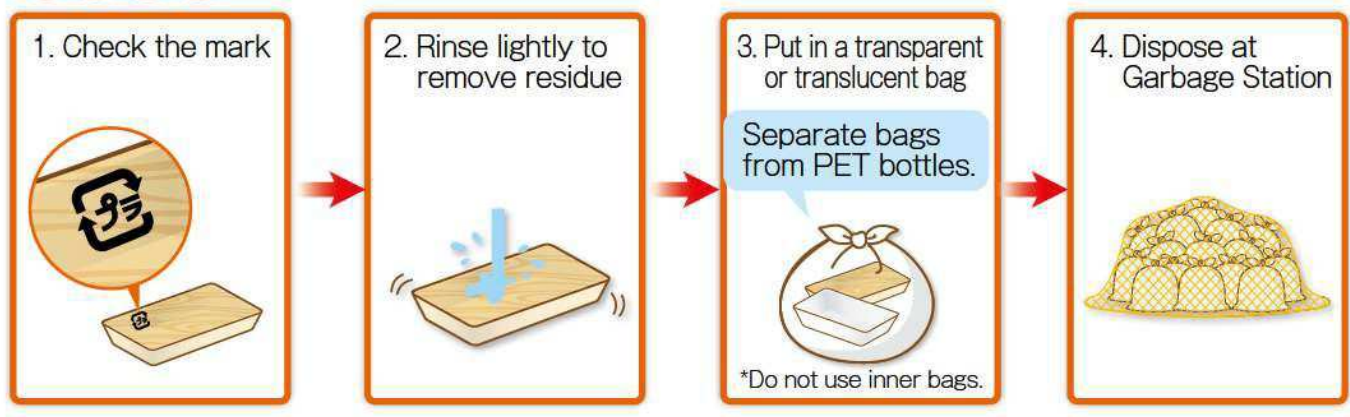

Applicable items

<p>Containers for sauce, cooking oil, dressing, etc.</p>	<p>Containers for detergent, shampoo, conditioner, etc.</p>	<p>Trays for meat or fish, and lunch box containers of convenience stores and supermarkets</p>	<p>Plastic caps, PET bottle labels</p>
<p>Bags for confectioneries, bread, vegetables, etc.</p>	<p>Bags for clothing, shopping bags</p>	<p>Containers for cup noodles, pudding, jelly, yogurt</p>	<p>Egg packs, tofu packs</p>

Non-applicable items

<p>Items which have a plastic mark and which cannot be cleaned</p> <p>Burnable Garbage</p>	<p>PET bottles</p> <p>PET Bottles</p>	<p>Plastic products that do not have the plastic mark</p> <p>Crushable Garbage</p>	<p>Styrofoam rolls (Whether there is a plastic mark or not.)</p> <p>Crushable Garbage</p>
---	--	---	--

Items collected at garbage stations / Collection times (once a week)

PET Bottles



Put in a transparent or translucent bag.

Please check the collection days on the Clean Calendar.

Transparent or translucent bag

Disposal

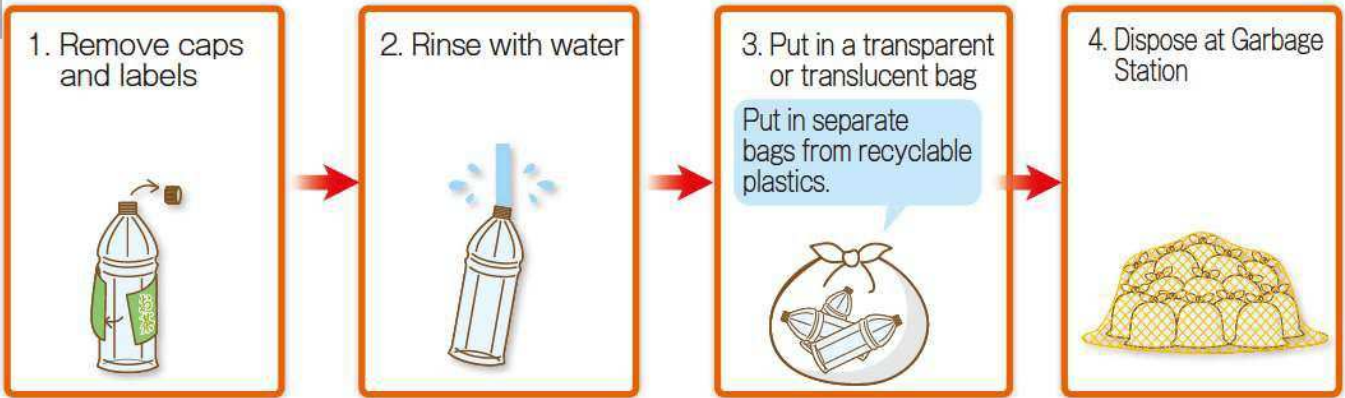

Applicable items



When disposing of PET bottles

- Put in separate bags from recyclable plastics.
- Make sure they do not get blown by wind such as by putting a net over.



Non-applicable items

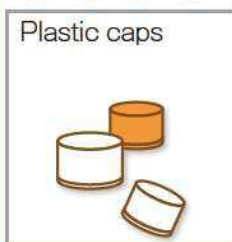

These items are **Recyclable Plastics.**

Items collected at garbage stations / Collection times (once every 4 weeks)

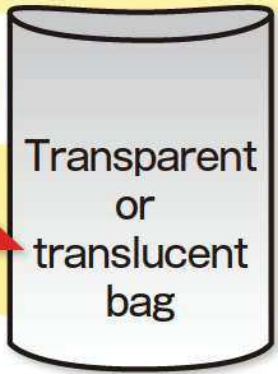

Hazardous Garbage

Put in a transparent or translucent bag.

Please check the collection days on the Clean Calendar.

Disposal

A 1. Put in a transparent or translucent bag

*Separate with B

2. Dispose at Garbage Station

B 1. Put in a transparent or translucent bag

*Separate with A

2. Dispose at Garbage Station

When disposing of hazardous garbage

Hazardous garbage can cause fires in garbage trucks or cause injury to garbage collectors. Do not mix it with other types of garbage.

*Check page 26 for details.



Applicable items

A Fluorescent lights

Thermometer (Uses mercury)

*Digital thermometers are crushable garbage.

Batteries (Uses mercury)

Mercury-free items are crushable garbage. Bring rechargeable batteries to the retailer.
*Check page 26 for details.

B Gas lighters

Spray cans

*Do not pierce holes.
*Please use the contents completely.

Blades

*Wrap blades in paper, etc.

Needles

*Put the item in a sealed container and write what is inside.

Items collected at garbage stations / Collection times (once every 4 weeks)



Crushable Garbage

Please put in designated garbage bags for disposal.

Please check the collection days on the Clean Calendar.

Disposal

1. Put in a designated garbage bag

Please remove rechargeable batteries (such as lithium and NiCad batteries) which can be removed.

*Check page 26 for details.



2. Dispose at Garbage Station

If your garbage does not fit in the 45 L crushable garbage designated bag, tie it with a string or the like and bring it to a garbage station.

Applicable items

Small appliances (under 60 cm)

Pots, rice cookers, toasters

Dryers, irons

Video tape decks, DVD players

Mobile phones, cameras, game consoles

Other daily necessities (under 120 cm) *Items under 30 cm that do not contain metal may be disposed of as burnable garbage.

Plastic products without the plastic mark

Pots, kettles

Light bulbs, batteries (mercury-free)

*Put batteries containing mercury in Hazardous Garbage.
*Bring rechargeable batteries to the retailer.

Styrofoam (Whether there is a plastic mark or not.)

Non-applicable items

Microwave ovens

Bulky Garbage

4 Special Appliances (televisions, refrigerators, freezers, clothes washers, clothes driers, air conditioners)

*Check page 14 for details

4 Special Appliances

Computers

*Check page 15 for details

Computers

Items collected at garbage stations / Collection times (Once every 8 weeks)

Cloths

Please check the collection days on the Clean Calendar.

Put in a transparent or translucent bag.

Transparent or translucent bag

Disposal

1. Put in a transparent or translucent bag



2. Dispose at Garbage Station



Please do not bring cloths to garbage stations in rainy weather.

Cloths can be brought to collection points (Recycling Stations, Environment Center).

*Check page 27 for details.

Applicable items

Clothing



Handkerchiefs, towels



Curtains

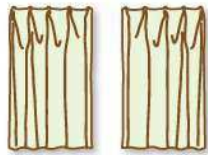

Sheets

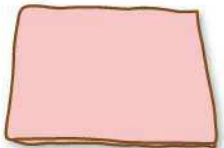

Non-applicable items

Wet items



Burnable Garbage

Soiled items



Burnable Garbage

Severely damaged items



Burnable Garbage

Underwear



Burnable Garbage

Rugs, carpets



Bulky Garbage

Futons, blankets, sitting cushions, mattresses



Bulky Garbage

Stuffed Toys



Crushable Garbage

Pillows, other cushion



Crushable Garbage

Items collected at garbage stations / Collection times (Once every 8 weeks)

Landfill Garbage

Put in a transparent or translucent bag.

Transparent or translucent bag

Please check the collection days on the Clean Calendar.

Disposal

1. Put in a transparent or translucent bag



When disposing of broken glass, clearly label the contents and put it in a cardboard box.

2. Dispose at Garbage Station



Put the whole cardboard box into a bag if you dispose garbage in cardboard boxes on rainy days.

Can also be brought straight to the recycling plant.

*Check page 27 for details.

Applicable items

Broken bottles



Ceramic containers



Glass products



Concrete blocks

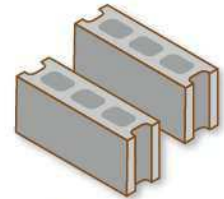

*Break it down to 50 cm or shorter.

Non-applicable items

Unbroken bottles



Bottles & Cans

Glass products which have non-glass parts that cannot be taken off



Crushable Garbage

Plastic flowerpots



Crushable Garbage

Pots, kettles



Crushable Garbage

Let's all work together to preserve our natural resources by separating and recycling our rubbish.



かん田きょう子さんと
そうじろう

Items not collected at garbage stations

Waste Paper

(Newspapers, fliers, magazines, mixed paper, cardboard, milk cartons, etc.)

Waste paper is a resource. Please do not dispose it as burnable garbage.

Disposal

1. Cross tie each type separately with string



1. Put mixed paper in paper bags or in magazines



Take off the clips

Or

1. Wash, open, and dry milk cartons before cross tying them

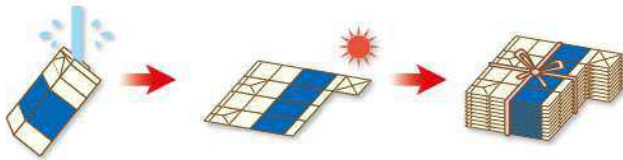

2. Bring to the designated locations

- Use local resource collection
- *Conducted by local residents' associations or PTAs
- Bring to a recycling station
- Bring to an environment center
- Bring to the Waste Paper Recycle Yard
- Bring to private waste paper collector sites



*You cannot dispose at Garbage Stations

Details of the disposal locations can be checked on an app to promote sorting garbage called "San aru"

You can set the notification settings of garbage collection days, and check the sorting of garbage, garbage collection days, and garbage collection facilities. Available in foreign languages (English, Português, Tagalog, Español, 汉语).

*Free to register and use, but subject to data fees.

Register from here!



App Store

Google Play



Applicable items

Newspapers, fliers

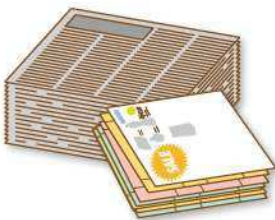

Magazines



Cardboard

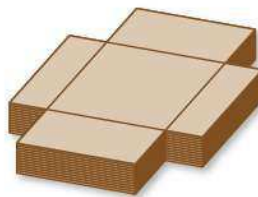

Milk cartons, etc.

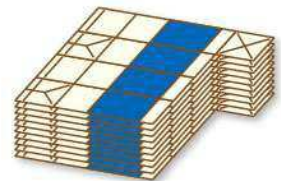

*Paper cartons for milk or juice

Mixed paper

Paper boxes, tissue boxes

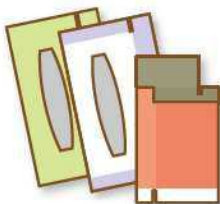

Envelopes, postcards, paper bags



Wrapping paper, pamphlets, copy paper, etc.

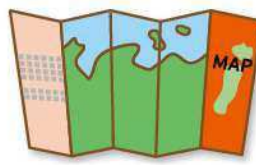

Toilet paper tubes



Items not collected at garbage stations

Bulky Garbage

Disposal

How to ask the city to collect the garbage (Not free)

1. Call the Home Collection Reception Center
 -Hours: Weekdays, 9:00 AM - 12:00 PM, 1:00 PM - 4:00 PM (Excluding weekends, holidays, and the new year)
 -TEL: (0532) 69-0530
2. Buy a bulky garbage certificate
 Estimated collection fee: Around 500 ~ 1,500 yen.

3. Dispose bulky garbage
 Put the bulky garbage certificate (seal) on the garbage.



How to bring to the Resource Recovery Center yourself (Free)

1. Bring to the Resource Recovery Center



*You cannot dispose at Garbage Stations

● **Resource Recovery Center**

-Hours:
 Weekdays, 9:00 AM - 12:00 PM, 1:00 PM - 4:00 PM
 Sunday, 9:00 AM - 12:00 PM, 1:00 PM - 4:00 PM
 (Reservation by phone is required)
 (Excluding Saturday, holidays, and the new year)
 -Address: 530 Nishi, Aza, Hōei-chō
 -TEL: (0532) 46-5304

Applicable items

Designated Items *These items are considered to be "bulky garbage" regardless of their size

<p>Microwave ovens</p> 	<p>Carpets, futons, blankets</p> 	<p>Beds, mattresses</p> 	<p>Chairs, desks, kotatsu</p> 	<p>Bicycles</p>  <p>*Cancel bicycle theft prevention registration first.</p>
--	--	---	--	---

Non-designated Items *Please check the size.

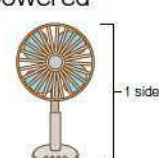
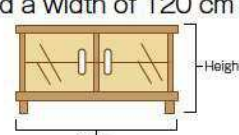
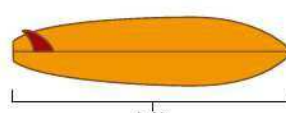
<p>Electric, gas, or oil powered appliances with one side 60 cm or more</p> 	<p>Furniture with a height of 90 cm or higher and a width of 120 cm or more</p> 	<p>Other items with one side over 120 cm in length</p> 
---	---	--

Items not collected at garbage stations

4 Special Appliances

Disposal

How to ask the city to collect the garbage (Not free)







How to bring items to the manufacturer's designated collection location yourself (Not free)

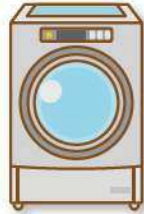

*Appliances retailers are legally obliged to take back the 4 special appliances. In principle, please request the retailer to take the item back.

Applicable items

<p>Televisions</p>  <p>*Organic electroluminescence TVs are not applicable.</p>	<p>Refrigerators, freezers</p> 	<p>Washing machines, clothes driers</p> 	<p>Air conditioners (including outdoor units)</p> 
--	--	--	---

Items not collected at garbage stations

Computers

Disposal

● Disposal at a Resource Recovery Center or Environment Center (East, South, West) (free)

- | | | |
|----------------------------|---------------------------------------|---------------------|
| ○ Resource Recovery Center | 530 Nishi, Aza, Hōei-chō | TEL: (0532) 46-5304 |
| ○ East Environment Center | 11-19 Takayama, Aza, Imure-chō | TEL: (0532) 61-4136 |
| ○ South Environment Center | 24 Hojido, Aza, Higashinanane-chō | TEL: (0532) 48-6693 |
| ○ West Environment Center | 46-1 Kyonowari, Aza, Jinnoshinden-chō | TEL: (0532) 32-9231 |

● Request to a business operator certified by the Small Appliance Recycling Law

● Disposal at the plant (free) *Some fees may be charged

○ Benikyū, Inc.

- | | | |
|--------------------|-------------------------------------|---------------------|
| -Head Office Plant | 12 Chinowari, Aza, Jinnoshinden-chō | TEL: (0532) 32-8888 |
| -East Plant | 90 Motoyashiki, Aza, Mitsuya-chō | TEL: (0532) 41-2344 |

*Check with certified business operators regarding the collection items and operating hours.

● Collection by home delivery service (Not free)

○ Renet Japan Recycle, Inc.

<https://www.renet.jp>

*Can apply from the homepage.

● Request to Manufacturers

Apply for collection to the manufacturer's customer service department.
If you cannot find the customer service department or manufacturer, check below.

○ PC 3R Promotion Association (<https://www.pc3r.jp>)

TEL: 03-5282-7685 FAX: 03-3233-6091

*Collection and resource recovery fees are required for PCs without the PC recycle mark.



Applicable items



This includes items with only display.



そうじょう



かん田きょう子さん

Items collected at garbage stations

Small Appliances

Disposal

Can also be disposed as crushable garbage at the Garbage Station.

● Disposal at a Resource Recovery Center or Environment Center (East, South, West) (free)

- | | | |
|----------------------------|---------------------------------------|---------------------|
| ○ Resource Recovery Center | 530 Nishi, Aza, Hōei-chō | TEL: (0532) 46-5304 |
| ○ East Environment Center | 11-19 Takayama, Aza, Imure-chō | TEL: (0532) 61-4136 |
| ○ South Environment Center | 24 Hojido, Aza, Higashinanane-chō | TEL: (0532) 48-6693 |
| ○ West Environment Center | 46-1 Kyonowari, Aza, Jinnoshinden-chō | TEL: (0532) 32-9231 |

● Disposal at small appliance collections sites (18 in the city)

● Collection of appliances under 60 cm

- Environment Center (East, South, West), Recycling Stations (Azumada)

● Collection of small appliance under 27 cm wide × 16 cm high × 30 cm long

- Recycling Stations (AEON Toyohashi Minami-ten, Azumada), City Hall, Service Counter Center (8 in the city), Public Health Care Centers, Development Center for Children's Futures, Audio Visual Education Center, Central Library, Environment Centers (East, South, West),



● Request to a business operator certified by the Small Appliance Recycling Law

● Disposal at the plant (free) *Some fees may be charged

○ Benikyū, Inc.

- Head Office Plant 12 Chinowari, Aza, Jinnoshinden-chō TEL: (0532) 32-8888
- East Plant 90 Motoyashiki, Aza, Mitsuya-chō TEL: (0532) 41-2344

*Check with certified business operators regarding the collection items and operating hours.

● Collection by home delivery service (Not free)

○ Renet Japan Recycle, Inc.

<https://www.renet.jp>

*Can apply from the homepage.

Applicable items

Delete personal information before disposing.

Pots, rice cookers, toasters



Dryers, irons



Video tape decks, DVD players

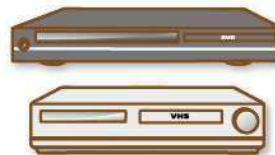

Mobile phones, cameras, game consoles



Household Garbage Category Guide (Alphabetical Order)

Item	Type of Garbage	Remarks
A AC adapters	Crushable Garbage	
Accordion curtains	Bulky Garbage	Put items under 120 cm long in Crushable Garbage.
Agar	Kitchen Waste	
Air cleaners	Crushable Garbage	Put in Bulky Garbage if 60 cm or longer
Air conditioners	4 Special Appliances	Have retailers take back the 4 special appliances.
Air cooler (With Freon gas)	Not Collected	Have the store take back the item.
Air pumps	Crushable Garbage	
Alarm clocks	Crushable Garbage	
Albums	Crushable Garbage	
Aluminum cans	Bottles & Cans	
Aluminum foil	Crushable Garbage	
Aluminum window frames	Bulky Garbage	Garbage produced as a byproduct of construction is not accepted by the city.
Aprons	Cloths	Can also be collected at environment centers or recycling stations.
Aquariums	Crushable Garbage	Put in Bulky Garbage if 120 cm or longer
Aromatics	Crushable Garbage	
Artificial turf (plastic)	Crushable Garbage	
Ash	Burnable Garbage	Dampen with water first.
Ashtrays (glass/ceramic)	Landfill Garbage	Put metal items in Crushable Garbage
Athletic shoes (sneakers)	Burnable Garbage	
Attache cases	Crushable Garbage	
Audio players	Crushable Garbage	
Automobiles	Not Collected	Have the store take back the item.
Automotive supplies	Crushable Garbage	
B Baby baths (plastic)	Crushable Garbage	Put in Bulky Garbage if 120 cm or longer
Baby bean chairs	Crushable Garbage	
Baby bottles	Crushable Garbage	
Baby carriages	Crushable Garbage	Put in Bulky Garbage if 120 cm or longer
Baby cots	Bulky Garbage	
Baby fences (non-wooden)	Crushable Garbage	Put in Bulky Garbage if 120 cm or longer
Baby fences (wooden)	Burnable Garbage	Cut to 60 cm or shorter and bundle together. Crushable garbage if it is between 120-60cm Put items 120 cm or longer in Bulky Garbage
Baby food	Crushable Garbage	
Baby racks	Crushable Garbage	
Backpacks (randset)	Burnable Garbage	
Backpacks (rucksacks)	Burnable Garbage	
Bags	Burnable Garbage	
Ballpoint pens	Crushable Garbage	
Balls	Crushable Garbage	

Item	Type of Garbage	Remarks
B Bamboo	Burnable Garbage	Cut to 60 cm or shorter and bundle together. Make 120 cm or shorter if bringing directly to facilities
Bamboo shoot skin	Kitchen Waste	
Barley tea packs	Kitchen Waste	
Bath boilers (heaters)	Bulky Garbage	Garbage produced as a byproduct of construction is not accepted by the city.
Bath chairs (plastic)	Crushable Garbage	Put wooden items in Burnable Garbage
Bath lids (plastic)	Crushable Garbage	Put in Bulky Garbage if 120 cm or longer
Bath lids (wooden)	Burnable Garbage	Cut to 60 cm or shorter and bundle together. Crushable garbage if it is between 120-60cm Put items 120 cm or longer in Bulky Garbage
Bath mats (Diatomaceous earth)	Landfill Garbage	
Bath mats (plastic)	Crushable Garbage	Put in Bulky Garbage if 120 cm or longer
Bath mats (wooden)	Burnable Garbage	Cut to 60 cm or shorter and bundle together. Crushable garbage if it is between 120-60cm Put items 120 cm or longer in Bulky Garbage
Bath wash tubs	Bulky Garbage	Garbage produced as a byproduct of construction is not accepted by the city.
Bathroom mats	Crushable Garbage	
Bathroom scales	Crushable Garbage	
Bathtubs	Bulky Garbage	Garbage produced as a byproduct of construction is not accepted by the city.
Bats (wooden)	Burnable Garbage	Put non-wooden items in Crushable Garbage.
Batteries	Not Collected	Have the store take back the item.
Batteries (dry-cell, mercury free)	Crushable Garbage	Bring rechargeable batteries to the retailer. Put batteries containing mercury in Hazardous Garbage.
Bean paste	Kitchen Waste	
Beanbags	Crushable Garbage	
Bed mats	Bulky Garbage	
Beds	Bulky Garbage	Disassemble first.
Beer bottles	Bottles & Cans	Can also be collected at retailers. Put caps in Crushable Garbage.
Belts	Burnable Garbage	
Bento boxes, food containers (plastic)	Recyclable Plastics	Clean first. Put leftovers in Kitchen Waste
Beverage cans	Bottles & Cans	
Bicycle tires/tubes	Crushable Garbage	
Bicycles	Bulky Garbage	
Bicycles (electric)	Bulky Garbage	Have the retailer take back batteries.
Bicycles (motorized)	Not Collected	Have the store take back the item.
Bird cages (wooden)	Burnable Garbage	Put non-wooden items in Crushable Garbage.
Blankets	Bulky Garbage	
Blinds	Crushable Garbage	Put in Bulky Garbage if 120 cm or longer
Blocks (concrete)	Landfill Garbage	Garbage produced as a byproduct of construction is not accepted by the city. Break it down to 50 cm or shorter
Boards (wood)	Burnable Garbage	Cut to 60 cm or shorter and bundle together. Make 120 cm or shorter if bringing directly to facilities
Boats	Not Collected	Have the store take back the item. Put rubber boats in Crushable Garbage
Bones	Kitchen Waste	
Bonito flakes	Kitchen Waste	

*Dispose "crushable garbage", non-metallic items under 30 cm can be put in "burnable garbage". (Except for electric, gas, or oil powered items.)
 *Dispose exterior boxes and bags from kitchen waste according to the garbage sorting rules.

	Item	Type of Garbage	Remarks
B	Books	Waste Paper	
	Bookshelves	Bulky Garbage	Put items under 90 cm long in Crushable Garbage
	Boots	Crushable Garbage	
	Bowling balls	Landfill Garbage	
	Bread	Kitchen Waste	
	Bricks	Landfill Garbage	Garbage produced as a byproduct of construction is not accepted by the city.
	Broken glass and bottles	Landfill Garbage	
	Bubble wrap (cushioning material)	Recyclable Plastics	
	Buckets	Crushable Garbage	
	Butters	Kitchen Waste	
C	Cables	Crushable Garbage	
	Calculators	Crushable Garbage	
	Cameras	Crushable Garbage	
	Candles	Burnable Garbage	
	Candy	Kitchen Waste	
	Canned food cans	Bottles & Cans	
	Car navigation systems	Crushable Garbage	
	Caramel	Kitchen Waste	
	Cardboard	Waste Paper	
	Cardboard (paperboard)	Waste Paper	
	Carpets	Bulky Garbage	
	Cash cards (magnetic card etc.)	Crushable Garbage	
	Cassette stoves	Crushable Garbage	Remove the cylinder from cassette types.
	Cassette tapes	Crushable Garbage	
	Cassette type gas cylinders	Hazardous Garbage	Please use the contents completely. Do not pierce holes.
	Cat litter	Burnable Garbage	
	Castings	Crushable Garbage	
	Catalogs	Waste Paper	
	CD cases	Crushable Garbage	
	CDs	Crushable Garbage	
	Cellophane	Burnable Garbage	
	Ceramics	Landfill Garbage	
	Chains	Crushable Garbage	
	Chairs	Bulky Garbage	Put legless chairs in Crushable Garbage
	Cheese	Kitchen Waste	
	Chest of drawers	Bulky Garbage	Put items under 90 cm long in Crushable Garbage
	Child car seats	Crushable Garbage	
	Child seats	Crushable Garbage	

	Item	Type of Garbage	Remarks
C	Chocolate	Kitchen Waste	
	Chopsticks (wooden)	Burnable Garbage	Put non-wooden items in Crushable Garbage
	Cinders (from bath heating, barbecue charcoal, etc.)	Burnable Garbage	Dampen first so the cinders do not scatter.
	Clay	Crushable Garbage	
	Clocks	Crushable Garbage	Put in Bulky Garbage if 120 cm or longer
	Clocks (desktop type)	Crushable Garbage	
	Clothes dryer	4 Special Appliances	Have retailers take back the 4 special appliances.
	Clothes drying rack	Crushable Garbage	Put in Bulky Garbage if 120 cm or longer
	Clothing	Cloths	Can also be collected at environment centers or recycling stations.
	Coagulated cooking oil	Burnable Garbage	
	Coffee bottles	Bottles & Cans	Put plastic lids in the Recyclable Plastics
	Coffee grounds, shells	Kitchen Waste	Can be disposed of with the coffee filter.
	Computer mouse (for PC)	Crushable Garbage	
	Concrete blocks	Landfill Garbage	Garbage produced as a byproduct of construction is not accepted by the city. Break it down to 50 cm or shorter
	Confectionery boxes	Waste Paper	
	Cooking oil	Burnable Garbage	Wipe up with a cloth or paper, so dry with a so drying agent and put in Burnable Garbage, or put in a container and bring to a recycling station.
	Cooking oil containers (glass/metal)	Bottles & Cans	Use the contents completely. If the item cannot be fully cleaned, put it in Crushable Garbage.
	Cooking oil containers (plastic)	Recyclable Plastics	Use the contents completely. If the item cannot be fully cleaned, put it in Burnable Garbage.
	Cooler boxes	Crushable Garbage	
	Cooler, Hot/cold storage (using electricity)	4 Special Appliances	These are includes in the 4 special appliances. Have the retailer take it back.
	Coolers	4 Special Appliances	Have retailers take back the 4 special appliances.
	Copiers	Crushable Garbage	Put in Bulky Garbage if 60 cm or longer
	Cords	Crushable Garbage	
	Corn husks	Kitchen Waste	
	Cosmetic tubes	Crushable Garbage	
	Cosmetics bottles	Bottles & Cans	Use the contents completely. Put items with contents remaining in Crushable Garbage.
	Costume cases	Crushable Garbage	Put in Bulky Garbage if 120 cm or longer
	Cotton	Burnable Garbage	
	Crab shells	Kitchen Waste	
	Crayons	Crushable Garbage	
	Cupboards	Bulky Garbage	Put items under 90 cm long in Crushable Garbage
	Cups (glass/ceramic)	Landfill Garbage	Put items that are not glass or ceramic in Crushable Garbage.
	Curry roux	Kitchen Waste	
	Curtain rails	Crushable Garbage	Garbage produced as a byproduct of construction is not accepted by the city. Put items 120 cm or longer in Bulky Garbage
	Curtains	Cloths	Can also be collected at environment centers or recycling stations.
	Cushion (For cotton seats)	Bulky Garbage	Put items other than cushions containing cotton in Crushable Garbage
	Cushions	Crushable Garbage	Put in Bulky Garbage if 120 cm or longer
	Cut flowers	Burnable Garbage	

*Dispose*crushable garbage*, non-metallic items under 30 cm can be put in *burnable garbage*. (Except for electric, gas, or oil powered items.)
 *Dispose exterior boxes and bags from kitchen waste according to the garbage sorting rules.

	Item	Type of Garbage	Remarks
C	Cutter knives	Hazardous Garbage	Wrap blades in paper, etc.
	Cutting boards (plastic)	Crushable Garbage	Put wooden items in Burnable Garbage
D	Dehumidifiers	Crushable Garbage	
	Dehumidifier (With Freon gas)	Not Collected	Have the store take back the item.
	Dentures	Crushable Garbage	
	Deodorant	Crushable Garbage	
	Desiccants	Crushable Garbage	
	Desk lamps	Crushable Garbage	Put in Bulky Garbage if 60 cm or longer
	Desks	Bulky Garbage	
	Detergent containers (plastic)	Recyclable Plastics	Use the contents completely and wash lightly.
	Dialysis tubes/bags	Burnable Garbage	Take off the needles and dispose them in hazardous garbage.
	Diapers	Burnable Garbage	Remove excrement.
	Diatomaceous earth products	Landfill Garbage	For products containing asbestos, please ask the manufacturer to take them back.
	Digital cameras	Burnable Garbage	
	Dish dryers	Crushable Garbage	Put in Bulky Garbage if 60 cm or longer
	Dishes (glass/ceramic)	Landfill Garbage	Put plastic items in Crushable Garbage. Put wooden items in Burnable Garbage
	Dishwasher-dryers	Bulky Garbage	
	Disposable chopsticks	Burnable Garbage	
	Disposable diapers	Burnable Garbage	Remove excreta first.
	Disposable heating pads	Crushable Garbage	
	Disposable lighters	Hazardous Garbage	
	Dog houses	Crushable Garbage	Put items 90 cm or longer in Bulky Garbage (same as furniture)
	Dolls/Doll cases	Crushable Garbage	Put in Bulky Garbage if 120 cm or longer
	Door mats	Crushable Garbage	Put in Bulky Garbage if 120 cm or longer
	Doors	Bulky Garbage	
	Dough/Bread crumbs	Kitchen Waste	
	Dressing container (plastic)	Recyclable Plastics	Put items with the PET mark with PET bottles. Put items that cannot be fully cleaned in Burnable Garbage
	Dried mushrooms	Kitchen Waste	
	Drugs	Burnable Garbage	
	Drugs (strong drugs)	Not Collected	Have the store take back the item.
	Dry matter	Kitchen Waste	
	DVD players	Crushable Garbage	
	DVDs	Crushable Garbage	
	E	Edamame peels	Kitchen Waste
Egg packs		Recyclable Plastics	Put paper items in Burnable Garbage
Egg shells		Kitchen Waste	
Electones		Bulky Garbage	
Electric blankets		Bulky Garbage	

	Item	Type of Garbage	Remarks	
E	Electric carpets	Bulky Garbage		
	Electric cords	Crushable Garbage		
	Electric guitars	Bulky Garbage		
	Electric pianos	Not Collected	Have the store take back the item.	
	Electric pots	Crushable Garbage		
	Electric razors	Crushable Garbage		
	Electric rice cooker	Crushable Garbage		
	Electrical organs	Bulky Garbage		
	Electronic pianos	Bulky Garbage	Put items under 60 cm long in Crushable Garbage.	
	Engine oil	Not Collected	Have the store take back the item. It cannot be collected even if it is disposed in a commercially available box.	
	Engine oil cans	Crushable Garbage		
	Envelopes	Waste Paper		
	Extension cords	Crushable Garbage		
	F	Fallen leaves	Burnable Garbage	
		Fan heaters	Crushable Garbage	Put in Bulky Garbage if 60 cm or longer
Fans		Crushable Garbage	Put in Bulky Garbage if 60 cm or longer	
Farm tools (hoes, picks etc.)		Hazardous Garbage	Items used in home gardens only. Wrap blades in paper or the like.	
Fax machines		Crushable Garbage	Put in Bulky Garbage if 60 cm or longer	
Fertilizer bags		Burnable Garbage	Items used in home gardens only.	
Figurines (glass/ceramic)		Landfill Garbage	Put wooden items in Burnable Garbage and plastic items in Crushable Garbage.	
Files		Crushable Garbage		
Film		Burnable Garbage	Put unused items (in the case) in Crushable Garbage.	
Fire extinguishers		Not Collected		
Firelighters		Hazardous Garbage		
Fireworks		Burnable Garbage	Use completely and submerge in water. Return unused items to the retailer	
Fish		Kitchen Waste		
Fishing line		Burnable Garbage		
Fishing rods		Crushable Garbage	Put in Bulky Garbage if 120 cm or longer	
Flashlights		Crushable Garbage		
Floor mats (rushes)		Bulky Garbage		
Floppy disks		Crushable Garbage		
Flour		Kitchen Waste		
Flowerpots (ceramic)		Landfill Garbage	Put plastic items in Crushable Garbage. Take off the roots and dirt.	
Flowers		Burnable Garbage		
Fluorescent tube (bulb-type)		Hazardous Garbage		
Fluorescent tubes		Hazardous Garbage		
Flyers		Waste Paper		
Forks		Crushable Garbage	Put wooden items in Burnable Garbage	

*Dispose "crushable garbage", non-metallic items under 30 cm can be put in "burnable garbage". (Except for electric, gas, or oil powered items.)

*Dispose exterior boxes and bags from kitchen waste according to the garbage sorting rules.

Item	Type of Garbage	Remarks
F Freezers	4 Special Appliances	Have retailers take back the 4 special appliances.
Frozen food	Kitchen Waste	
Frozen meat, fish	Kitchen Waste	
Fruit peels and pits	Kitchen Waste	
Fruits	Kitchen Waste	
Frying pans	Crushable Garbage	
Full-length mirrors	Crushable Garbage	Put in Bulky Garbage if 120 cm or longer
Furikake	Kitchen Waste	
Fusuma panels	Bulky Garbage	
Futon dryers	Crushable Garbage	
Futons	Bulky Garbage	
G Game consoles	Crushable Garbage	
Game software	Crushable Garbage	
Gas cylinders (Propane gas cylinder)	Not Collected	Have the store take back the item.
Gas fan heaters	Crushable Garbage	Put in Bulky Garbage if 60 cm or longer
Gas lighters	Hazardous Garbage	
Gas oven ranges	Bulky Garbage	Put items under 60 cm in length with now microwave function in Crushable Garbage
Gas ovens	Crushable Garbage	Put in Bulky Garbage if 60 cm or longer
Gas rice cookers	Crushable Garbage	
Gas stoves	Crushable Garbage	Put in Bulky Garbage if 60 cm or longer
Gelatin	Kitchen Waste	
Glass bottles	Bottles & Cans	
Glass cleaner (pump type)	Recyclable Plastics	Remove the pump part and put in Crushable Garbage.
Glass cleaner (spray type)	Hazardous Garbage	Please use the contents completely. Do not pierce holes.
Glass doors	Bulky Garbage	Garbage produced as a byproduct of construction is not accepted by the city.
Glass plates	Landfill Garbage	Put in Bulky Garbage if 120 cm or longer
Glass products	Landfill Garbage	
Glass wool	Landfill Garbage	Garbage produced as a byproduct of construction is not accepted by the city
Glasses	Crushable Garbage	
Gloves	Burnable Garbage	
Gloves (work gloves)	Burnable Garbage	
Glow lamps	Crushable Garbage	
Glue (stationery)	Recyclable Plastics	Put items that cannot be cleaned in Burnable Garbage
Gold fish bowls (glass)	Landfill Garbage	Put plastic items in Crushable Garbage
Golf balls	Crushable Garbage	
Golf clubs/Golf bags	Crushable Garbage	Put in Bulky Garbage if 120 cm or longer
Grass (Weeds)	Burnable Garbage	
Grass cutters	Crushable Garbage	Only includes items used at home. Put items 60 cm or longer in Bulky Garbage

Item	Type of Garbage	Remarks
G Grindstone	Landfill Garbage	
Guitars	Crushable Garbage	Put in Bulky Garbage if 120 cm or longer
Gum (chewing gum)	Burnable Garbage	
Gypsum boards	Landfill Garbage	Garbage produced as a byproduct of construction is not accepted by the city.
H Hair dryers	Crushable Garbage	
Hair spray	Hazardous Garbage	Please use the contents completely. Do not pierce holes.
Halogen heaters	Crushable Garbage	Put in Bulky Garbage if 60 cm or longer
Hammers	Crushable Garbage	
Handbags	Burnable Garbage	
Hand-held fireworks	Burnable Garbage	Disassemble ropes to 50cm or less and bamboo to 60cm or less. Crushable garbage if metal is used.
Handkerchiefs	Cloths	Can also be collected at environment centers or recycling stations.
Hanger (plastic)	Crushable Garbage	Return cleaning hangers to the cleaners as much as possible. Put wooden items in Burnable Garbage
Hard disk	Crushable Garbage	
Hats	Cloths	Can also be collected at environment centers or recycling stations.
Health care equipment	Crushable Garbage	Put in Bulky Garbage if 120 cm or longer (60 cm or longer for electric models)
Heating pads (disposable)	Crushable Garbage	
Heat-resistant glass	Landfill Garbage	
Helmets	Crushable Garbage	
Highlighters	Crushable Garbage	
Home bakeries	Crushable Garbage	Put in Bulky Garbage if 60 cm or longer
Honey	Kitchen Waste	
Hose reels	Crushable Garbage	
Hoses	Crushable Garbage	
Hot carpets	Bulky Garbage	
Hot plates	Crushable Garbage	Put in Bulky Garbage if 60 cm or longer
Hot-water bottles	Crushable Garbage	
House paint	Not Collected	Have the store take back the item.
House paint cans	Crushable Garbage	Use the contents completely.
I Ice packs	Crushable Garbage	
IH stoves	Crushable Garbage	Put in Bulky Garbage if 60 cm or longer
Incandescent light bulbs	Crushable Garbage	
Ink cartridges	Crushable Garbage	Can also be collected at retailers.
Inkan (personal seals)	Crushable Garbage	Put wooden items in Burnable Garbage
Insect cages (plastic)	Crushable Garbage	Put wooden items in Burnable Garbage
Insect catching nets	Crushable Garbage	Put items 120 cm or longer in Burnable Garbage.
Insecticide (smoking agent)	Crushable Garbage	Put unused items in Hazardous Garbage.
Insecticide (spray can)	Hazardous Garbage	Please use the contents completely. Do not pierce holes.
Instant coffee	Hazardous Garbage	

*Dispose*crushable garbage*, non-metallic items under 30 cm can be put in *burnable garbage*. (Except for electric, gas, or oil powered items.)
 *Dispose exterior boxes and bags from kitchen waste according to the garbage sorting rules.

	Item	Type of Garbage	Remarks
I	Instant coffee bottles	Bottles & Cans	
	Iron scraps	Recyclable Plastics	Put in Bulky Garbage if 120 cm or longer
	Ironing boards	Crushable Garbage	
	Irons (steam irons)	Crushable Garbage	
	Isshobin (1.8 L bottles)	Bottles & Cans	Can also be collected at retailers. Put caps in Crushable Garbage.
	Isshobin lids	Recyclable Plastics	
J	Ittokan (18 L cans)	Crushable Garbage	Please use the contents completely.
	Jam	Kitchen Waste	
	Japanese clothes	Cloths	Can also be collected at environment centers or recycling stations.
	Jelly	Kitchen Waste	
	Jet skis	Not Collected	Have the store take back the item.
	Joinery	Bulky Garbage	
K	Joint mats	Crushable Garbage	
	Jump ropes	Crushable Garbage	
	Kelp	Kitchen Waste	
	Kerosene	Not Collected	Have the store take back the item.
	Kerosene cans	Crushable Garbage	
	Kerosene polytank	Crushable Garbage	
L	Kerosene pumps	Crushable Garbage	
	Ketchup containers	Burnable Garbage	Please use the contents completely. Put bottles in bottles & cans.
	Kettles	Crushable Garbage	
	Keyboards (personal computers)	Crushable Garbage	
	Kimonos	Cloths	Can also be collected at environment centers or recycling stations.
	Kinako (roasted soy flour)	Kitchen Waste	
	Kitchen knives	Hazardous Garbage	Wrap blades in paper, etc.
	Kitchen mats	Crushable Garbage	Put in Bulky Garbage if 120 cm or longer
	Kitchen mats (natural fiber/chemical fiber)	Crushable Garbage	Put in Bulky Garbage if 120 cm or longer
	Knits	Cloths	Can also be collected at environment centers or recycling stations.
	Knitting machines	Crushable Garbage	Put in Bulky Garbage if 120 cm or longer (60 cm or longer for electric models)
	Knives	Hazardous Garbage	Wrap blades in paper, etc.
	Konjac	Kitchen Waste	
	Kotatsu (heated table)	Bulky Garbage	
	Kotatsu floor pads	Bulky Garbage	
	Kotatsu futon	Bulky Garbage	
	Koto	Bulky Garbage	
	Ladders	Bulky Garbage	
	Laptops	Computers	There are multiple methods of disposal. Please see 15 page.
	Laundry poles	Crushable Garbage	Put in Bulky Garbage if 120 cm or longer

	Item	Type of Garbage	Remarks	
L	Lawn mowers	Crushable Garbage	Only includes items used at home. Put items 60 cm or longer in Bulky Garbage	
	LCD televisions	4 Special Appliances	Have retailers take back the 4 special appliances.	
	Leather goods	Burnable Garbage		
	LED light bulbs	Crushable Garbage		
	Light bulbs (including LED bulbs)	Crushable Garbage		
	Lighters	Hazardous Garbage		
	Lighting equipment	Crushable Garbage	Put in Bulky Garbage if 60 cm or longer	
	Lip creams	Crushable Garbage		
	Lipstick	Crushable Garbage		
	Lithium ion batteries	Not Collected	See page 26.	
	Lunch boxes (non-wood)	Crushable Garbage	Put wooden items in Burnable Garbage	
	Lunch thermos	Crushable Garbage		
	M	Macaroni	Kitchen Waste	
		Machetes	Hazardous Garbage	Wrap blades in paper, etc.
Magazines		Waste Paper		
Magnets		Crushable Garbage		
Magnifying glasses		Crushable Garbage		
Manicure bottles		Bottles & Cans	Use the contents completely. Put items with contents remaining in Crushable Garbage.	
Margarines		Kitchen Waste		
Masks		Burnable Garbage		
Massage machines (chair type)		Bulky Garbage	Put non-chair type machines that are under 60 cm in length in Crushable Garbage	
Matches		Burnable Garbage	Use completely and submerge in water.	
Mattresses		Bulky Garbage		
Mattress pads		Bulky Garbage	Crushable garbage if it does not have cotton inside.	
Mayonnaise		Kitchen Waste		
Mayonnaise containers		Burnable Garbage	Please use the contents completely. Put bottles in bottles & cans.	
MD cases		Crushable Garbage		
MDS (Mini discs)		Crushable Garbage		
Meat		Kitchen Waste		
Mechanical pencils		Crushable Garbage		
Medicine		Burnable Garbage		
Medicine (capsule packaging)		Crushable Garbage	Put items with the plastic mark on them in Recyclable Plastics	
Medicine bottles		Bottles & Cans		
Microwave oven stands		Crushable Garbage	Put items 90 cm or longer in Bulky Garbage	
Microwave ovens		Bulky Garbage		
Milk cartons		Waste Paper		
Milk powder		Kitchen Waste		
Milk powder cans		Bottles & Cans	Put plastic lids in the Recyclable Plastics	

*Dispose "crushable garbage", non-metallic items under 30 cm can be put in "burnable garbage". (Except for electric, gas, or oil powered items.)

*Dispose exterior boxes and bags from kitchen waste according to the garbage sorting rules.

	Item	Type of Garbage	Remarks	
M	Mirror stands	Crushable Garbage	Put items 90 cm or longer in Bulky Garbage	
	Mirrors	Crushable Garbage	Put in Bulky Garbage if 120 cm or longer	
	Miso	Kitchen Waste		
	Mobile phones	Crushable Garbage	Erase personal information first.	
	Mochi	Kitchen Waste		
	Moldy food	Kitchen Waste		
	Mops	Crushable Garbage	Put in Bulky Garbage if 120 cm or longer	
	Motorcycles	Not Collected	Have the store take back the item.	
	Mushrooms	Kitchen Waste		
	Mustard	Kitchen Waste		
	Nail clippers	Hazardous Garbage		
N	Nails	Hazardous Garbage	Put in a container.	
	Natto	Kitchen Waste		
	Neck ties	Cloths	Can also be collected at environment centers or recycling stations.	
	Needles	Hazardous Garbage	Put them in a sealed container and clearly label the contents before disposal	
	Negative film	Burnable Garbage	Put unused items (in the case) in Crushable Garbage.	
	Nets holding mandarin oranges	Crushable Garbage		
	Newspapers	Waste Paper		
	Ni-Cd battery	Not Collected	See page 26.	
	Lighters	Kitchen Waste		
	Notebooks	Waste Paper		
	Nukadoko (salted rice bran)	Kitchen Waste		
	O	Oil cans (cooking oil)	Crushable Garbage	Bring the contents to a recycling station
		Oil fan heaters	Crushable Garbage	Put in Bulky Garbage if 60 cm or longer
		Oil heaters	Crushable Garbage	Put in Bulky Garbage if 60 cm or longer
Oil stoves		Crushable Garbage	Put in Bulky Garbage if 60 cm or longer	
Okayu (rice porridge)		Kitchen Waste		
Old clothes		Cloths	Can also be collected at environment centers or recycling stations.	
Onion peels		Kitchen Waste		
Organ (instrument)		Bulky Garbage		
P		Paint	Not Collected	Have the store take back the item.
		Paint cans	Crushable Garbage	Use the contents completely.
	Paint tubes	Crushable Garbage		
	Pamphlets	Waste Paper		
	Paper boxes /Paper bags	Waste Paper		
	Paper cups	Burnable Garbage		
	Paper packs (white inside)	Waste Paper	Put items with a silver lining in Burnable Garbage	
	Parabolic antenna	Crushable Garbage	Garbage produced as a byproduct of construction is not accepted by the city.	

	Item	Type of Garbage	Remarks
P	Peanut shells	Kitchen Waste	
	Pencil sharpeners	Crushable Garbage	
	Pencils	Burnable Garbage	
	Perfume bottles	Bottles & Cans	Use the contents completely.
	Personal computer tables	Crushable Garbage	Put items 90 cm or longer in Bulky Garbage
	Personal computers (desktop)	Computers	There are multiple methods of disposal. Please see 15 page.
	Pesticide	Not Collected	Have the store take back the item.
	PET bottle caps	Recyclable Plastics	
	PET bottle labels	Recyclable Plastics	
	PET bottles	PET Bottles	Remove caps and labels and put them in Recyclable Plastics.
	Pet droppings	Burnable Garbage	
	Pet food	Kitchen Waste	
	Pet litter	Burnable Garbage	
	Photo negative film	Burnable Garbage	Put unused items (in the case) in Crushable Garbage.
	Photographs	Burnable Garbage	
	Pianos	Not Collected	Have the store take back the item.
	Pickled plum seeds	Kitchen Waste	
	Pickles	Kitchen Waste	
	Picnic sheets	Crushable Garbage	
	Picture books	Waste Paper	
	Picture frames	Crushable Garbage	Put in Bulky Garbage if 120 cm or longer
	Pillows (natural material)	Burnable Garbage	Put in Bulky Garbage if 120 cm or longer
	Pillows (non-natural materials)	Crushable Garbage	Put in Bulky Garbage if 120 cm or longer
	Pinholders (for flowers, etc.)	Hazardous Garbage	
	Pipe hangers/Hanger racks	Crushable Garbage	Put in Bulky Garbage if 120 cm or longer
	Pistachio shells	Kitchen Waste	
	Pizzas	Kitchen Waste	
	Plant branches and leaves	Burnable Garbage	Cut to 60 cm or shorter and bundle together. Make 120 cm or shorter if bringing directly to facilities
	Planters (ceramic)	Landfill Garbage	Put plastic items in Crushable Garbage. Take off the roots and dirt.
	Plastic bags	Recyclable Plastics	
	Plastic models	Recyclable Plastics	
	Plate glass	Landfill Garbage	Put in Bulky Garbage if 120 cm or longer
	Plush dolls	Crushable Garbage	Put in Bulky Garbage if 120 cm or longer
	Plywood	Bulky Garbage	
	Polaroid photos	Burnable Garbage	
	Poly buckets	Crushable Garbage	
	Poly tanks	Crushable Garbage	
	Postcards	Waste Paper	

*Dispose*crushable garbage*, non-metallic items under 30 cm can be put in *burnable garbage*. (Except for electric, gas, or oil powered items.)
 *Dispose exterior boxes and bags from kitchen waste according to the garbage sorting rules.

	Item	Type of Garbage	Remarks
P	Pots	Crushable Garbage	
	Poultices	Burnable Garbage	
	Powdered cheese	Kitchen Waste	
	Powdered food	Kitchen Waste	
	Printer	Crushable Garbage	Put in Bulky Garbage if 60 cm or longer
	Projection TVs	Crushable Garbage	Put in Bulky Garbage if 60 cm or longer
	Pudding	Kitchen Waste	
R	Rackets	Crushable Garbage	
	Radio cassette players	Crushable Garbage	Put in Bulky Garbage if 60 cm or longer
	Radios	Crushable Garbage	Put in Bulky Garbage if 60 cm or longer
	Rags (floor cloths)	Burnable Garbage	Heavily soiled items cannot be recovered as resources.
	Rain coats/Rain boots	Crushable Garbage	
	Raincoats	Crushable Garbage	
	Ramen	Kitchen Waste	
	Raw rice	Kitchen Waste	
	Razors	Hazardous Garbage	Put in a container.
	Receipts	Burnable Garbage	
	Reception chairs	Bulky Garbage	
	Reception desks	Bulky Garbage	
	Rechargeable batteries	Not Collected	See page 26.
	Recorders (flutes)	Crushable Garbage	
	Records	Crushable Garbage	
	Red ink pads	Crushable Garbage	Hazardous garbage if mercury is used.
	Reed blinds	Burnable Garbage	Cut to 60 cm or shorter and bundle together. Crushable garbage if it is between 120~60cm. Put items 120 cm or longer in Bulky Garbage
	Reels (fishing tackle)	Crushable Garbage	
	Refrigerators	4 Special Appliances	Have retailers take back the 4 special appliances.
	Remote controllers	Crushable Garbage	
	Retort pouches	Recyclable Plastics	Put items that cannot be cleaned in Burnable Garbage
	Rice	Kitchen Waste	
	Rice bran	Kitchen Waste	
	Rice cookers	Crushable Garbage	
	Rice crackers	Kitchen Waste	
	Rice milling machines	Crushable Garbage	Put in Bulky Garbage if 60 cm or longer
	Rice vermicelli	Kitchen Waste	
	Roller skates	Crushable Garbage	
	Roof tiles	Landfill Garbage	Garbage produced as a byproduct of construction is not accepted by the city.
	Rope	Crushable Garbage	Put items with natural materials in Burnable Garbage
	Rotten food	Kitchen Waste	

	Item	Type of Garbage	Remarks
R	Rubber bands	Crushable Garbage	
	Rubber boats	Crushable Garbage	Have the retailer take back FRP boats.
	Rubber boots	Crushable Garbage	
	Rubber gloves	Crushable Garbage	
	Rubber hoses	Crushable Garbage	
	Rugs/Center rugs	Bulky Garbage	
	S	Safes	Bulky Garbage
Safety boots		Crushable Garbage	
Safety pins		Crushable Garbage	
Sake packs (silver lining)		Burnable Garbage	
Salt		Kitchen Waste	
Sand		-	Sand is not garbage, so it cannot be transported to garbage treatment facilities.
Sandals		Burnable Garbage	
Sauce containers (plastic)		Recyclable Plastics	Use the contents completely. If the item cannot be fully cleaned, put it in Burnable Garbage.
Saws		Hazardous Garbage	Wrap blades in paper, etc.
Scanner		Crushable Garbage	
Scissors		Hazardous Garbage	Wrap blades in paper, etc.
Scrap fibers (cutting waste, cloth)		Burnable Garbage	
Screen door screens		Crushable Garbage	
Screen doors		Bulky Garbage	Garbage produced as a byproduct of construction is not accepted by the city.
Scrub brushes		Crushable Garbage	
Seashells/Oyster shells		Kitchen Waste	
Seasoning		Kitchen Waste	
Seasoning bottles		Bottles & Cans	Use the contents completely, and put the lids in Recyclable Plastics.
Seaweed (edible)		Kitchen Waste	
Seeds (vegetables/fruits)		Kitchen Waste	
Senior carts (electric cart)		Bulky Garbage	Have the retailer take back batteries.
Sesame seeds		Kitchen Waste	
Sewing machines (excluding desktop type)		Bulky Garbage	Put desktop types in Crushable Garbage
Shampoo bottles		Recyclable Plastics	Remove the pump part and put in Crushable Garbage.
Sheds		Bulky Garbage	Some items cannot be collected from homes, depending on their size or shape.
Sheets		Cloths	Can also be collected at environment centers or recycling stations.
Sheets (plastic)		Crushable Garbage	
Shelves (plywood)		Crushable Garbage	Put in Bulky Garbage if 120 cm or longer
Shirataki noodles		Kitchen Waste	
Shirts		Cloths	Can also be collected at environment centers or recycling stations.
Shoebboxes		Bulky Garbage	Put items under 90 cm long in Crushable Garbage
Shoes		Burnable Garbage	

*Dispose "crushable garbage", non-metallic items under 30 cm can be put in "burnable garbage". (Except for electric, gas, or oil powered items.)

*Dispose exterior boxes and bags from kitchen waste according to the garbage sorting rules.

	Item	Type of Garbage	Remarks
S	Shoji doors	Bulky Garbage	
	Shovels	Crushable Garbage	
	Shrimp shells	Kitchen Waste	
	Sickles	Hazardous Garbage	Wrap blades in paper, etc.
	Silica gel (desiccant)	Crushable Garbage	
	Sink basins	Crushable Garbage	
	Sitting chairs	Crushable Garbage	Put items with the legs on them in Bulky Garbage
	Skate shoes	Crushable Garbage	
	Skateboards	Crushable Garbage	
	Ski shoes	Crushable Garbage	
	Skis	Bulky Garbage	Put items under 120 cm long in Crushable Garbage.
	Slates	Landfill Garbage	Garbage produced as a byproduct of construction is not accepted by the city.
	Sleeping bags	Crushable Garbage	Put in Bulky Garbage if 120 cm or longer Bulky garbage if it has cotton inside.
	Slippers	Burnable Garbage	
	Snorkels (Diving equipment)	Crushable Garbage	
	Snowboards	Bulky Garbage	Put items under 120 cm long in Crushable Garbage.
	Soap	Burnable Garbage	
	Soba noodles	Kitchen Waste	
	Sofa beds	Bulky Garbage	
	Sofas	Bulky Garbage	
	Soil	-	Soil is not garbage. Please reuse it.
	Soil (Soil for gardening which was used in flower pots.)	-	Remove roots, stems, and leaves, and bring to an environment center or final disposal site. Limited to 15 kg per bag, 5 bags per day.
	Somen noodles	Kitchen Waste	
	Spaghetti	Kitchen Waste	
	Sponges	Crushable Garbage	
	Spoons	Crushable Garbage	Put wooden items in Burnable Garbage
	Spray cans	Hazardous Garbage	Please use the contents completely. Do not pierce holes.
	Staplers	Crushable Garbage	
	Staples	Crushable Garbage	
	Starch	Kitchen Waste	
	Steel cans	Bottles & Cans	
	Stepladders	Bulky Garbage	Put items under 120 cm long in Crushable Garbage.
	Stereos	Bulky Garbage	Put minicomponents in Crushable Garbage
Stew roux	Kitchen Waste		
Stockings	Burnable Garbage	Lightly soiled items can be disposed of as cloths.	
Stocks (for skiing)	Crushable Garbage	Put in Bulky Garbage if 120 cm or longer	
Stones (rocks)	-	Stones (rocks) are not garbage, so they cannot be transported to garbage processing facilities.	
Storage sheds	Bulky Garbage	Some items cannot be collected from homes, depending on their size or shape.	

	Item	Type of Garbage	Remarks	
S	Storm shutters	Bulky Garbage	Garbage produced as a byproduct of construction is not accepted by the city.	
	Stoves	Crushable Garbage	Put in Bulky Garbage if 60 cm or longer	
	Straw hats	Burnable Garbage		
	Straw paper	Waste Paper		
	Strawberry packs	Recyclable Plastics		
	Straws	Burnable Garbage		
	Straw mat	Bulky Garbage	Put items under 120 cm long in Crushable Garbage.	
	Strollers	Crushable Garbage	Put in Bulky Garbage if 120 cm or longer	
	Styrofoam	Crushable Garbage	Whether there is a plastic mark or not.	
	Sugar	Kitchen Waste		
	Suitcases	Crushable Garbage	Put in Bulky Garbage if 120 cm or longer	
	Surfboards	Bulky Garbage		
	Swabs	Burnable Garbage		
	Sweaters	Cloths	Can also be collected at environment centers or recycling stations.	
	Sweets	Kitchen Waste		
	Syringes	Hazardous Garbage	Put them in a sealed container and clearly label the contents before disposal	
	T	Table cloths	Cloths	Can also be collected at environment centers or recycling stations. Put vinyl items in Crushable Garbage
		Tables	Bulky Garbage	
		Tableware (glass/ceramic)	Landfill Garbage	Put plastic items in Crushable Garbage. Put wooden items in Burnable Garbage
		Tambourines	Landfill Garbage	
		Tarpaulins	Crushable Garbage	
		Tatami mats	Bulky Garbage	Tatami mats thrown out as part of tatami replacement by a business are not accepted by the city.
		Taxidermy	Crushable Garbage	Put in Bulky Garbage if 120 cm or longer
		Tea bags	Kitchen Waste	
		Tea cups (ceramic)	Landfill Garbage	
		Tea dregs	Kitchen Waste	
		Telephones	Crushable Garbage	
		Tempura	Kitchen Waste	
		Tempura Oil	Burnable Garbage	Wipe up with a cloth or paper, solidify with a solidifying agent and put in burnable garbage, or put in a container and bring to recycling station.
		Tennis rackets	Crushable Garbage	
		Tents	Crushable Garbage	Put in Bulky Garbage if 120 cm or longer
		Textbooks	Waste Paper	
		Thermal paper	Burnable Garbage	
Thermometer (digital type)		Crushable Garbage	Put items with mercury in them in Hazardous Garbage	
Thermometer (mercury free)		Crushable Garbage	Put items with mercury in them in Hazardous Garbage	
Thermos bottles		Crushable Garbage		
Thinner		Not Collected	Have the store take back the item	
Tin plates (metal)		Bulky Garbage	Garbage produced as a byproduct of construction is not accepted by the city. Put items 120 cm or shorter in Crushable Garbage	

*Dispose*crushable garbage*, non-metallic items under 30 cm can be put in *burnable garbage*. (Except for electric, gas, or oil powered items.)
 *Dispose exterior boxes and bags from kitchen waste according to the garbage sorting rules.

	Item	Type of Garbage	Remarks	
T	Tire chains	Crushable Garbage		
	Tire wheels	Crushable Garbage		
	Tires	Not Collected	Have the store take back the item. Put items for bicycles in Crushable Garbage	
	Tissues	Burnable Garbage		
	Toaster ovens	Crushable Garbage		
	Toasters	Crushable Garbage		
	Tobacco	Burnable Garbage		
	Tofu	Kitchen Waste		
	Toilet mats	Crushable Garbage		
	Toilet paper	Burnable Garbage		
	Toilet seat covers	Crushable Garbage		
	Toilet seats	Crushable Garbage	Put electric toilet seats that are 60 cm or longer in Bulky Garbage	
	Tomato ketchup	Kitchen Waste		
	Toner cartridges	Crushable Garbage	Can also be collected at retailers.	
	Tooth paste	Burnable Garbage		
	Toothbrushes	Crushable Garbage	Put items with natural materials in Burnable Garbage	
	Towel racks	Cloths	Can also be collected at environment centers or recycling stations.	
	Toys	Burnable Garbage	Put wooden items in Burnable Garbage. Put items 120 cm or longer in Bulky Garbage	
	Trays (food plastic)	Recyclable Plastics		
	Tree branches/Wood chips	Burnable Garbage	Cut to 60 cm or shorter and bundle together. Make 120 cm or shorter if bringing directly to facilities	
	Tricycles	Crushable Garbage		
	Triple mirrors	Crushable Garbage	Put items 90 cm or longer in Bulky Garbage	
	Tripods	Crushable Garbage	Put in Bulky Garbage if 120 cm or longer	
	Trunks	Crushable Garbage	Put in Bulky Garbage if 120 cm or longer	
	TV antennas	Crushable Garbage	Put in Bulky Garbage if 120 cm or longer	
	TV sets	4 Special Appliances	Have retailers take back the 4 special appliances.	
	TV stands	Crushable Garbage	Put items 90 cm or longer in Bulky Garbage	
	U	Udon noodles	Kitchen Waste	
		Umbrellas	Crushable Garbage	
		Underwear (natural fiber/chemical fiber)	Burnable Garbage	
		Unicycles	Crushable Garbage	Put in Bulky Garbage if 120 cm or longer.
		USB memory	Crushable Garbage	
V	Vacuum cleaners	Crushable Garbage	Bundle hoses. Put items 60 cm or longer in Bulky Garbage	
	Vases (glass/ceramics)	Landfill Garbage	Put items that are not glass or ceramic in Crushable Garbage.	
	Vegetable wastes/cores	Kitchen Waste		
	Ventilators	Crushable Garbage		
	Video cameras	Crushable Garbage		
	Video decks	Crushable Garbage		

	Item	Type of Garbage	Remarks
V	Video tapes	Crushable Garbage	
	Vinyl for gardening	Crushable Garbage	Items used in home gardens only.
	Vinyl sheets	Crushable Garbage	
	Vinyl string	Crushable Garbage	
W	Wakame (seaweed)	Kitchen Waste	
	Wall clocks	Crushable Garbage	Put in Bulky Garbage if 120 cm or longer
	Walnut shells	Kitchen Waste	
	Wasabi	Kitchen Waste	
	Wash tubs	Crushable Garbage	
	Washing machines	4 Special Appliances	Have retailers take back the 4 special appliances.
	Waste oil	Not Collected	Have the store take back the item.
	Watches	Crushable Garbage	
	Water bottles	Crushable Garbage	
	Water heater for baths	Bulky Garbage	Garbage produced as a byproduct of construction is not accepted by the city.
	Water heaters	Bulky Garbage	Garbage produced as a byproduct of construction is not accepted by the city.
	Water server	Not Collected	Have the store take back the item.
	Weight scales	Crushable Garbage	
	Wetsuits	Crushable Garbage	
	Wheelchairs	Bulky Garbage	
	Wine cases/Wine cellars	4 Special Appliances	These are included in the 4 special appliances. Have the retailer take it back.
	Wire	Crushable Garbage	
	Wire mesh	Crushable Garbage	Garbage produced as a byproduct of construction is not accepted by the city. Put items 120 cm or longer in Bulky Garbage
	Women's sanitary items	Burnable Garbage	
	Wood decks	Burnable Garbage	Cut to 60 cm or shorter and bundle together. Make 120 cm or shorter if bringing directly to facilities
	Wood fences	Burnable Garbage	Cut to 60 cm or shorter and bundle together. Make 120 cm or shorter if bringing directly to facilities
	Word processors	Crushable Garbage	
	Wrap	Burnable Garbage	
	Wrapping cloths	Cloths	Can also be collected at environment centers or recycling stations.
	Wrapping papers	Waste Paper	
	Y	Yakisoba noodles	Kitchen Waste
Yarn (natural fiber / chemical fiber)		Burnable Garbage	Put yarn sweaters in cloths
Yogurt		Kitchen Waste	
Yokan (azuki paste)		Kitchen Waste	

*Dispose "crushable garbage", non-metallic items under 30 cm can be put in "burnable garbage". (Except for electric, gas, or oil powered items.)
 *Dispose exterior boxes and bags from kitchen waste according to the garbage sorting rules.

Topics

Vehicle fire is a man-made disaster.



Vehicle fire of garbage trucks can lead to a fatal accident for workers and local residents. We ask to properly separate and dispose garbage, and to cooperate in preventing fire accidents.



▲ Spray cans and rechargeable lithium-ion batteries which were in the crushable garbage and thought to be the cause of the fire.

Spray cans and gas lighters are hazardous garbage, and lithium-ion batteries go to shops nearby where recycles batteries.

- Recycling Centers (General Incorporated Association) JBRC
TEL: 03-6403-5673 <https://www.jbrc.com>

Illegal dumping of garbage and taking resources are crimes

Illegal dumping of garbage

Randomly dumping away trash can result in a prison sentence of up to 5 years and a fine of up to ¥10,000,000 for individuals, or a prison sentence of up to 5 years and a fine of up to ¥300,000,000 for corporations.



Taking resources

Taking recyclable resources can result in a fine of up to ¥200,000.

*Resources: Cans, glass bottles, PET bottles, plastic containers and packaging, waste paper, cloths, electric appliances, metal products, and products containing metal.



List of facilities where garbage can be disposed

● Bulky Garbage

-Hours:
 Weekdays, 9:00 AM - 12:00 PM, 1:00 PM - 4:00 PM
 Sunday, 9:00 AM - 12:00 PM, 1:00 PM - 4:00 PM
 (Reservation by phone is required)
 (Only bulky garbage and computers)
 (Excluding Saturday, holidays, and the new year)
 -Address: 530 Nishi, Aza, Hōei-chō
 -TEL: (0532) 46-5304

*If there is a large amount of garbage such as due to moving, please bring them in by yourself.

Applicable items



● Environment Centers

-Hours:
 Weekdays, 9:00 AM - 12:00 PM, 1:00 PM - 4:00 PM
 (Excluding weekends, holidays, and the new year)
 ● East Environment Center
 -Address: 11-19 Takayama, Aza, Imure-chō
 -TEL: (0532) 61-4136
 ● South Environment Center
 -Address: 24 Hojido, Aza, Higashinanane-chō
 -TEL: (0532) 48-6693
 ● West Environment Center
 -Address: 46-1 Kyonowari, Aza, Jinnoshinden-chō
 -TEL: (0532) 32-9231

Applicable items

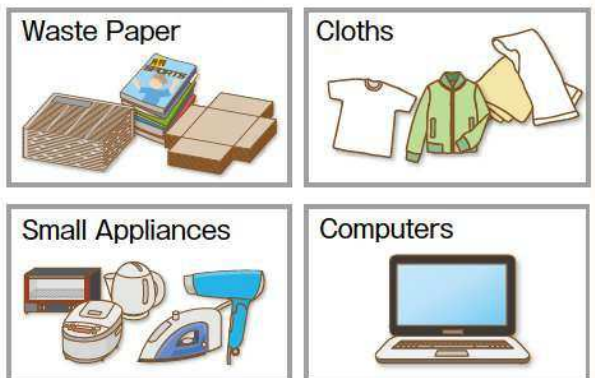

● Recycling Stations

-Hours: Every day, 1:00 PM - 5:00 PM
 (Excluding the new year and special closed days)
 ● AEON Toyohashi Minami-ten
 -Address: 1-12 Ochiai, Aza, Noyori-chō
 -TEL: (0532) 26-0053
 ● Azumada
 -Address: 30-4 Shinonome-chō
 -TEL: (0532) 63-6660

Applicable items



● Final Disposal Site

-Hours: Weekdays,
 9:00 AM - 12:00 PM, 1:00 PM - 4:00 PM
 (Excluding weekends, holidays, and the new year)
 -Address: 441 Higashi-ōnawate, Aza, Takatsuka-chō
 -TEL: (0532) 25-0145

Applicable items



List of facilities where garbage can be disposed

● **Okayamaken Kamotsu Unso, Inc. Toyokawa Office**

-Address: 10 Ichimichi, Shinoda-chō, Toyokawa-shi
 -TEL: (0533) 93-6535

Applicable items

4 Special Appliances

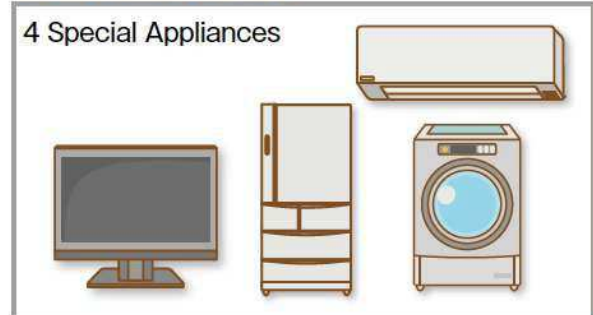

● **Nittsū Higashi Aichi Unyu, Inc. Head Sales Office**

-Address: 85-1 Shiroshita, Aza, Ushikubo-chō, Toyokawa-shi
 -TEL: (0533) 85-7890

Applicable items

4 Special Appliances

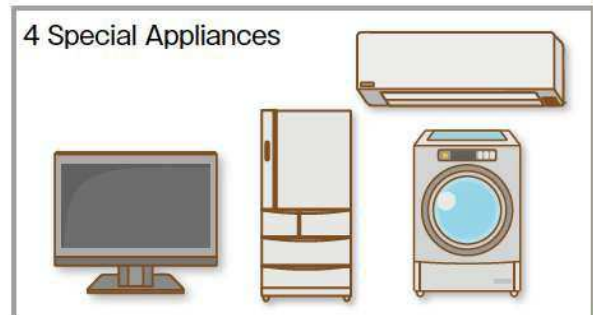

● **Benikyū, Inc. Head Office Plant**

-Address: 12 Chinowari, Aza, Jinnoshinden-chō
 -TEL: (0532) 32-8888

*Some fees may be charged.

Applicable items

Small Appliances



Computers

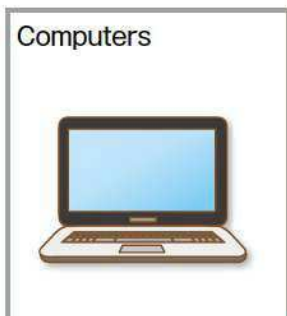

● **Benikyū, Inc. East Plant**

-Address: 90 Motoyashiki, Aza, Mitsuya-chō
 -TEL: (0532) 41-2344

*Some fees may be charged.

Applicable items

Small Appliances



Computers

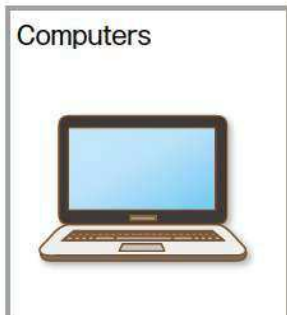

Garbage Disposal Map

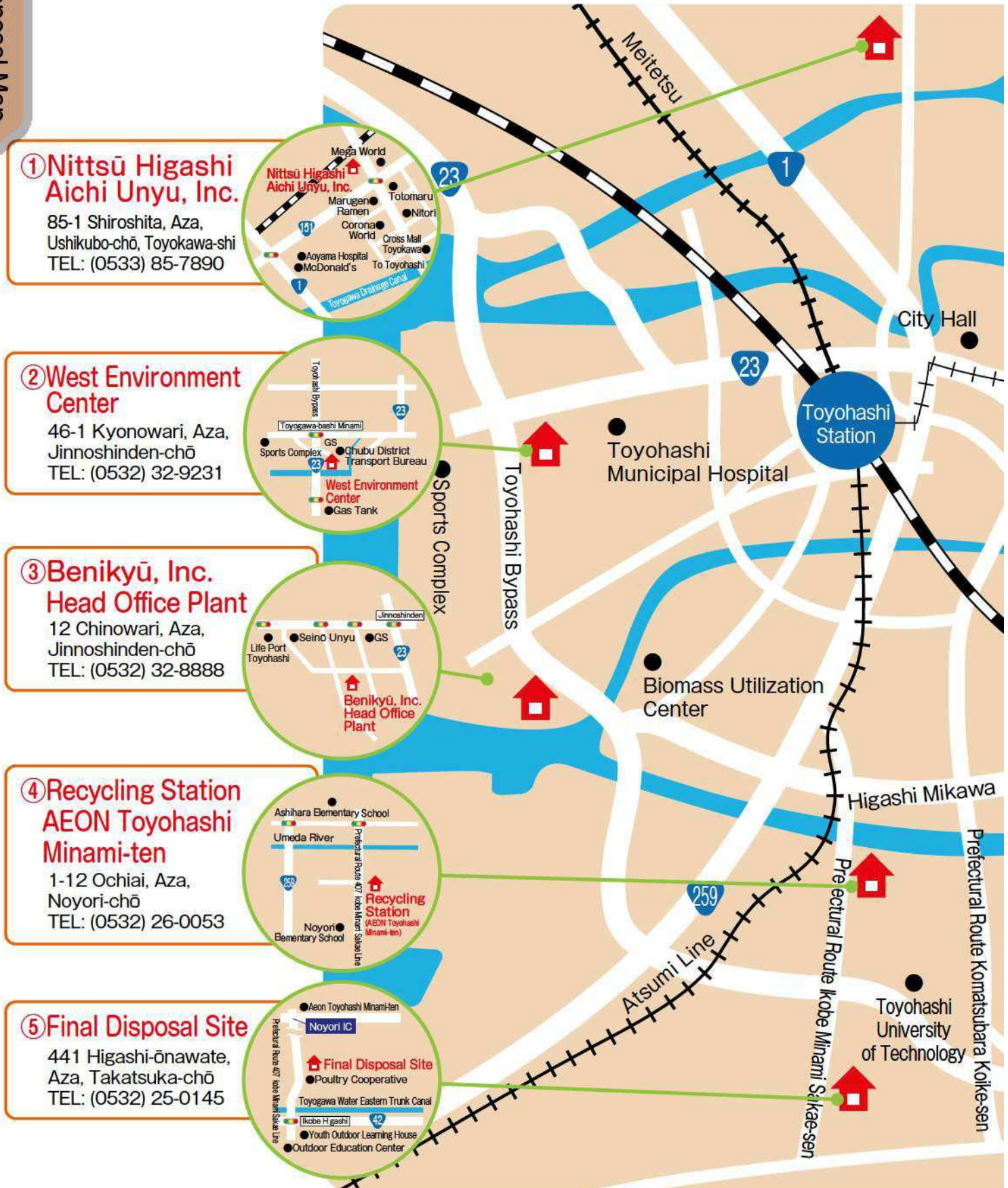

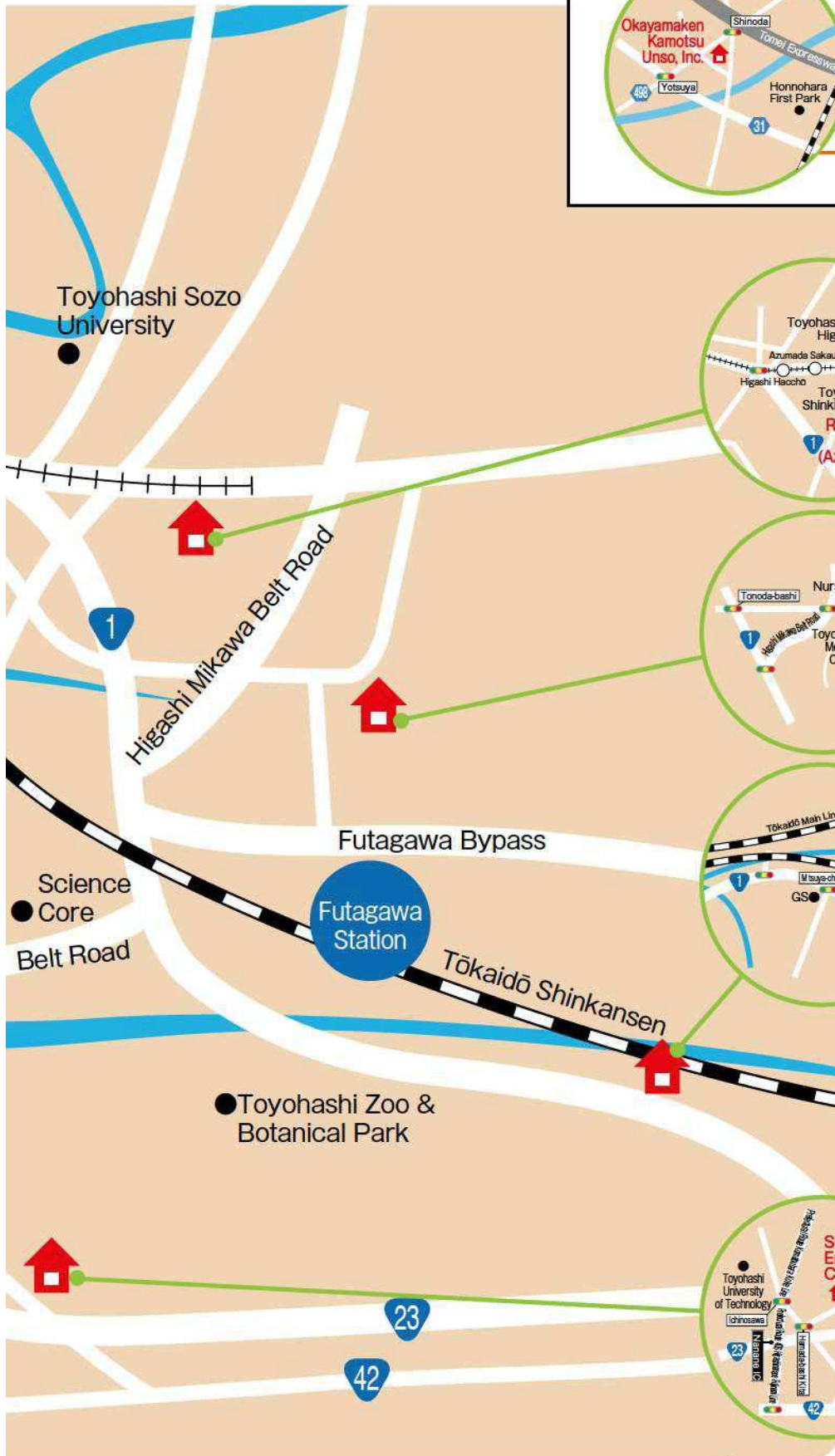

⑥ Okayamaken Kamotsu Unso, Inc.
 10 Ichimichi, Shinoda-chō,
 Toyokawa-shi
 TEL: (0533) 93-6535

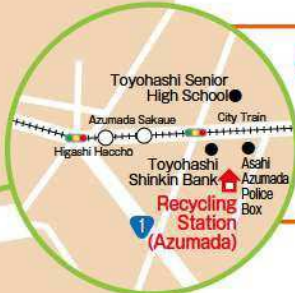

⑦ Recycling Station Azumada
 30-4 Shinonome-chō
 TEL: (0532) 63-6660



⑧ East Environment Center
 11-19 Takayama, Aza,
 Imure-chō
 TEL: (0532) 61-4136



⑨ Benikyū, Inc. East Plant
 90 Motoyashiki,
 Aza, Mitsuya-chō
 TEL: (0532) 41-2344



⑩ South Environment Center
 24 Hojido, Aza,
 Higashinanane-chō
 TEL: (0532) 48-6693

⑪ Resource Recovery Center
 530 Nishi, Aza, Hōei-chō
 TEL: (0532) 46-5304

Contact

Content	Contact
● Garbage sorting systems, local recycling collection, recycling stations, bulky garbage certificates	- Zero Carbon Promotion Division (City Hall West 5th Floor) TEL: (0532) 51-2399
● Collection and sorting of general household garbage	- East Environment Center (11-19 Takayama, Aza, Imure-chō) TEL: (0532) 61-4136
● Collection of deceased dogs and cats	*Funeral halls also accept deceased dogs (and cats) for disposal. (Not free) - Funeral Halls TEL: (0532) 61-2032
● Door to door collection of bulky garbage	- Home Collection Reception Center TEL: (0532) 69-0530 FAX: (0532) 66-5374 *Hours: Weekdays 9:00 AM - 12:00 PM, 1:00 PM - 4:00 PM (Except weekends, holidays, and New Year's)
● Matters concerning accepting large amounts of garbage	- Resource Recovery Center (530 Nishi, Aza, Hōei-chō) TEL: (0532) 46-5304
● Applications to deliver bulky garbage and computers yourself on Sundays (until the previous Friday)	
● Matters concerning acceptance of landfill garbage	- Final Disposal Site (441 Higashi-ōnawate, Aza, Takatsuka-chō) TEL: (0532) 25-0145
● Matters concerning business garbage	- Waste Management Section (City Hall West 5th Floor) TEL: (0532) 51-2410 - Illegal Dumping Report Free Hotline TEL: 0120-56-0552 FAX: 0120-56-0552
● Complaints concerning field burning	
● If you have discovered illegal dumping	
● To directly deliver 4 Special Appliances (televisions, refrigerators/freezers, clothes washers/driers, and air conditioners)	- Okayamaken Kamotsu Unso, Inc. Toyokawa Office TEL: (0533) 93-6535 - Nittsū Higashi Aichi Unyu, Inc. Head Office TEL: (0533) 85-7890 *Recycling fees must be paid at a post office before delivery
● To deliver small appliances (certified business operators)	- Benikyū, Inc. Head Office TEL: (0532) 32-8888 - Benikyū, Inc. East Plant TEL: (0532) 41-2344
● If you need an interpreter	- Multicultural Society & International Affairs Department TEL: (0532) 51-2023

From April 1, 2023, you will need to make a reservation to bring household garbage to the Resource Recovery Center (Shigenka Center).

Why are reservations now required?

We are introducing a reservation system for the Resource Recovery Center to reduce traffic on surrounding roads and ensure the safety of vehicles bringing in household waste. You can make reservations by phone or online beginning March 20, 2023. Please see “2. Reservations for bringing household garbage directly to the Resource Recovery Center, etc. (Free)” on the reverse of this flyer for information about making an appointment.

Bringing in household garbage properly

With the introduction of the reservation system, we ask for your cooperation in properly taking trash (crushable garbage, etc.) to the appropriate waste stations.

We kindly ask for and greatly appreciate your understanding and cooperation.

(Continued on reverse)

※The phone number for the Resource Recovery Center (Shigenka Center) will be changed from April 1, 2023.
0532-46-5304 → 0532-46-5303

The Household Garbage Call Center will be open from April 3, 2023 (Mon)



1. Household Garbage Inquiries

- Garbage collection
- Separation of garbage
- Disposal of large quantities of garbage
- Disposal of landfill garbage
- Disposal of the 4 major home appliances (Air conditioner, TV, Refrigerator/Freezer, Washing machine/dryer)
- Disposal of small household appliances

Hours: Weekdays (Mon-Fri) 8:30 - 17:00
TEL: 0532-69-0530

※Until March 31, 2023 (Fri), this number will connect to the Home Collection Reception Center

1. Household Garbage Inquiries
2. Reservations for bringing household garbage directly to the Resource Recovery Center, etc. (Free)
3. Reservations for door-to-door collection of bulky garbage (Paid)

You can make reservations online (24 hours/day)

2. Reservations for bringing household garbage directly to the Resource Recovery Center, etc. **(Free)**

- From April 1, 2023 (Sat), reservations are required (even on weekdays)!
- Excluding the New Year's holiday period, the Resource Recovery Center will accept reservations daily, including weekends and holidays.
- Temporary sites for bringing in your garbage will be set up at the East and West Environment Centers on the 3rd Saturday of every month and during busy seasons (Golden Week, Obon, New Year's holiday).
- Reservations can be made by phone or online!
- (Phone and online reservations will both begin on March 20, 2023 (Mon) at 9 AM)
- You can make reservations up to 2 months in advance. However, you cannot have multiple reservations.

3. Reservations for door-to-door collection of bulky garbage **(Paid)**

- You can make reservations over the phone or online!
(Note) If you are making a reservation for the first time, you must make it by phone.
- You can pay online when you make a reservation!
- Payment methods: PayPay, Credit Card (Visa, Mastercard, JCB)
- You can make reservations and payments for collections made from Monday, April 3, 2023 (reservations and online payments can be made from 9 AM on Sunday, March 20, 2023).

